



Chiltern Close, Benson, Oxfordshire
£290,000 Freehold

JAMESGESNER
- ESTATE AGENTS -

Located within this sought after development for the over 60's is this well presented two double bedroom terraced bungalow with its own patio garden and access to communal lawned gardens. The property has a new storage heater in living area and is classed as freehold with service and management charges of £2,256 per annum approximately which includes upkeep of the gardens and parking areas.



14 Chiltern Close, Benson, Oxfordshire, OX10 6LG

GROUND FLOOR
573 sq.ft. (53.2 sq.m.) approx.

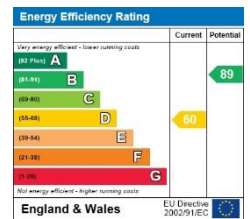
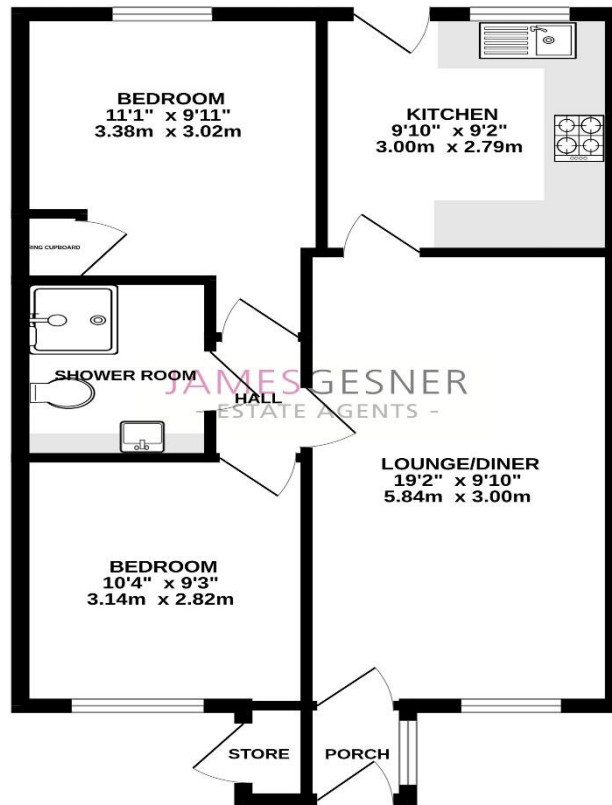

TOTAL FLOOR AREA : 573 sq.ft. (53.2 sq.m.) approx.
Whilst every attempt has been made to ensure the accuracy of the floorplan contained here, measurements of doors, windows, rooms and any other items are approximate and no responsibility is taken for any error, omission or mis-statement. This plan is for illustrative purposes only and should be used as such by any prospective purchaser. The services, systems and appliances shown have not been tested and no guarantee as to their operability or efficiency can be given.
Made with Metropix 6/2025



James Gesner Estate Agents
72 Broadway Didcot, Oxon OX11 8AE
info@jamesgesner.co.uk

t: 01235 519888
t: 01491 522222

Important Notice: These particulars have been prepared for prospective purchasers only. They are not part of an offer or contract. Whilst some descriptions are obviously subjective and information is given in good faith, they should not be relied upon as statements or representations of fact. We have not tested any appliances which may be included in the sale, therefore any purchaser should seek clarification prior to exchange of contracts.