



## Tabard Street, SE1

### £430,000

A beautifully presented almost 700 sq ft flat offering bright, spacious living with a private south west-facing balcony. Featuring a fully fitted modern kitchen, a generous living room, two double bedrooms, with ample room for storage, hard-wood floors, a stylish bathroom, and a separate WC. Offered chain free, with permit parking available.

Pallant House enjoys an enviable location, moments from the leafy calm of Tabard Gardens and the vibrant heart of Borough. Residents are a short stroll from Borough Market, the South Bank's cultural attractions, and the cafés and restaurants of Borough High Street, with Borough and London Bridge stations close by for easy connections across the city.

### Features

- Chain Free Sale
- Secure Entry & Lift Access
- Two Double Bedrooms
- Separate Kitchen
- Private Balcony
- South West-Facing

# Tabard Street, London, SE1

## Second Floor

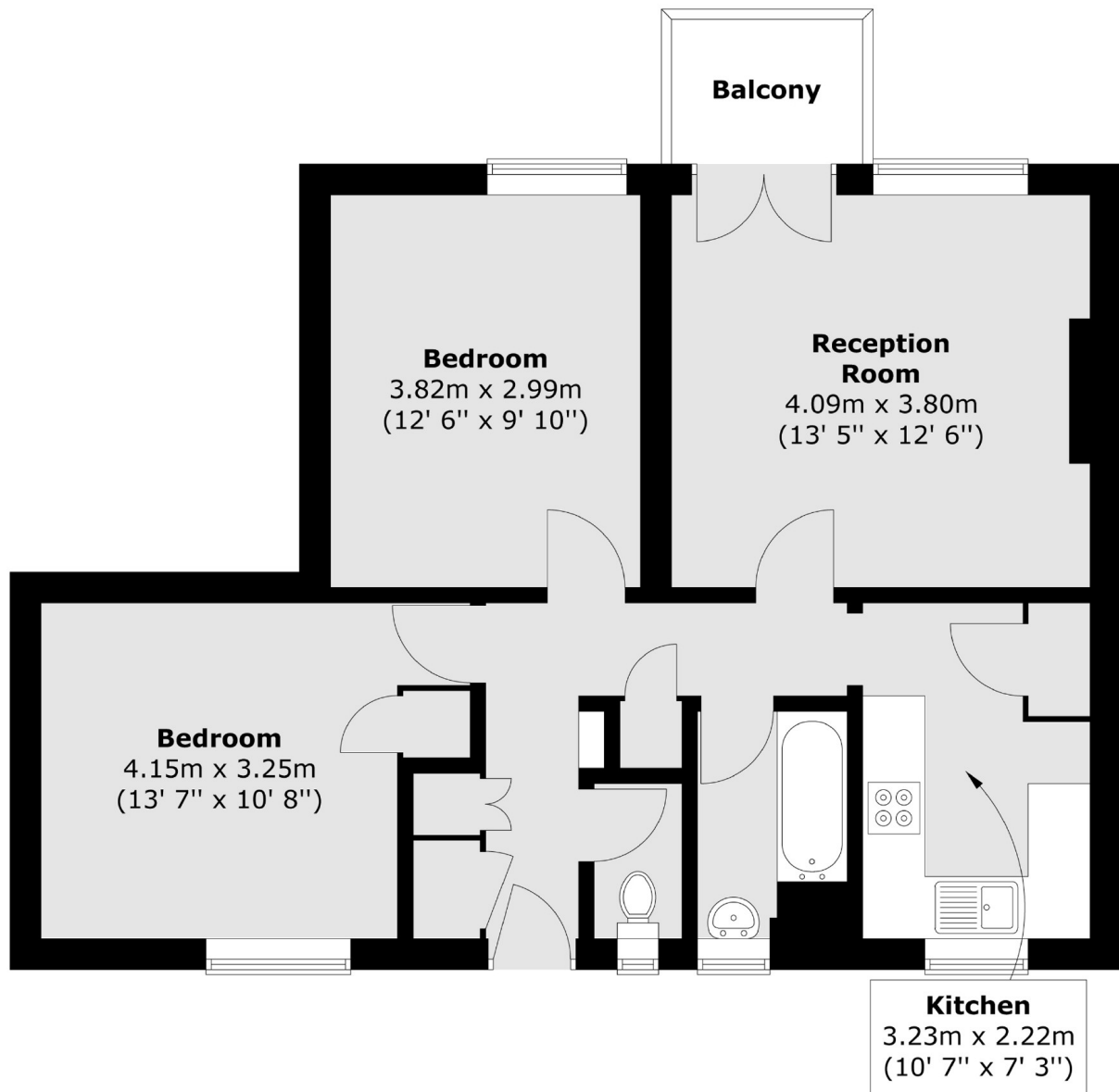

Total area (approx.) : 62.5 sq. m (673 sq. ft)  
Total balcony area (approx.) : 2.6 sq. m (28 sq. ft)