



## Alscot Road, SE1

### £300,000

A highly attractive Ground Floor Flat in a unique 1920s Art Deco Conversion with a newly extended lease, an open plan kitchen and living room, a three piece bathroom and a generous double bedroom, plus ample storage and access to a large, rooftop communal terrace. Sold chain free.

Solarium Court enjoys an enviable location, moments from Bermondsey Spa Gardens and the vibrant Bermondsey Street, renowned for its independent cafés, boutique shops and restaurants. The celebrated Maltby Street Market and Borough Market are also close by, offering some of London's finest food and produce. There are excellent transport links via London Bridge and Bermondsey Stations.

### Features

- Offers in excess of £300,000
- Long/Extended Lease
- Art Deco
- One Double Bedroom
- Communal Terrace
- Very Centrally Located
- Excellent Transport Links
- Chain Free Sale

# Alscot Road, London, SE1

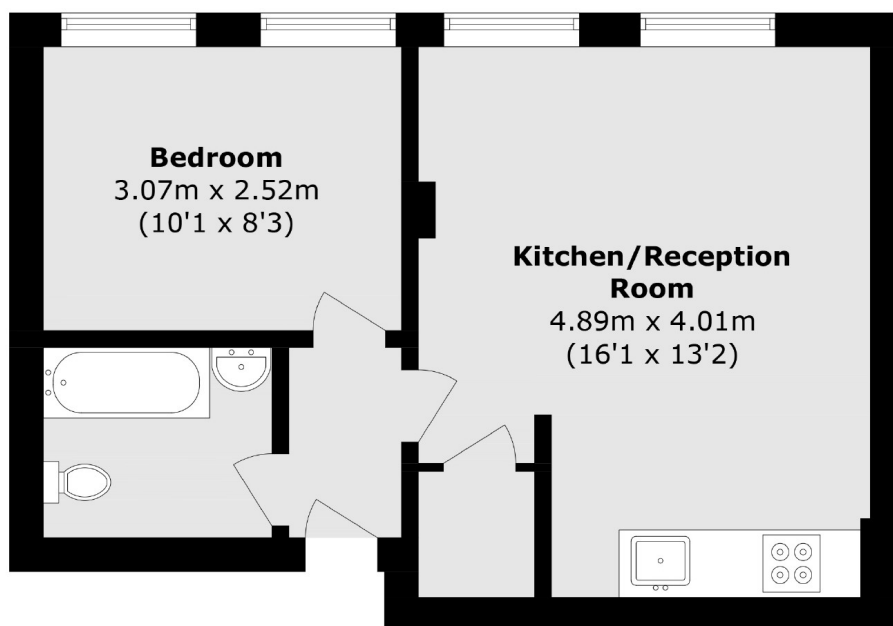

Total area (approx.): 34.1 sq. m (367 sq. ft)