



Southwark Bridge Road, SE1 £550,000

A smartly presented, modern apartment, on the second floor, with an open plan living room and fully fitted modern kitchen, leading out onto a south-east facing private balcony, two generous double bedrooms and ample storage. Sold Chain Free.

MyBase is in the heart of SE1, between Borough, Southwark, London Bridge and Elephant & Castle stations, with easy access to Bankside, Borough Market, Tate Modern & Globe Theatre. Westminster and the City are both within easy reach.

Features

- Valid EWS1 Form
- Two Double Bedrooms
- Private Balcony
- Secure Entry & Lift Access
- Central Location
- Excellent Transport Links
- Chain Free

Southwark Bridge Road, London, SE1

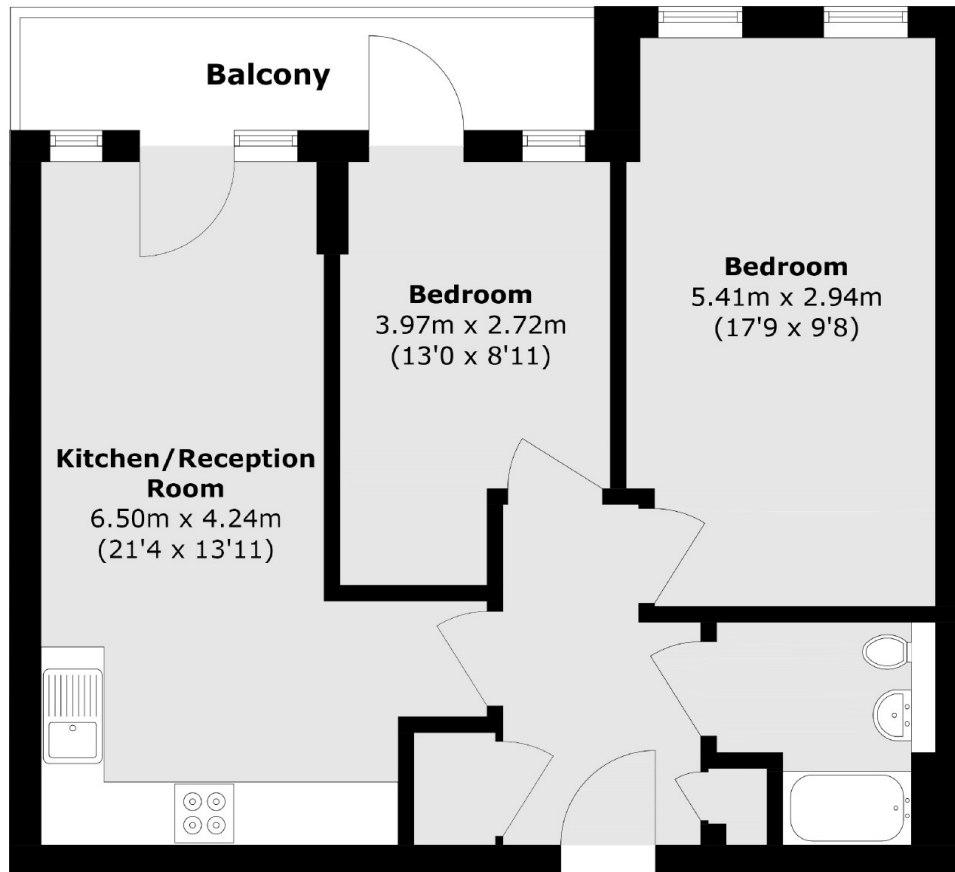

Total area (approx.): 58.7 sq. m (631.8 sq. ft)
Balcony area (approx.): 6.16 sq. m (66.3 sq. ft)