



Strathnairn Street, SE1

£750,000

A highly attractive freehold house, with a south facing garden, a generous fully fitted kitchen, a large living room, with ample room for dining, plus a conservatory, three bedrooms, a family bathroom and off-street parking.

Strathnairn Street is a quiet residential street, tucked back from Southwark Park Road and St James's Street, adjacent to Thoburn Square, within easy reach of both Bermondsey Underground & South Bermondsey Station.

Features

- Freehold House
- Three Bedrooms
- Large Living Room
- Separate Kitchen
- South-Facing Garden
- Solar Panels
- Off-Street Parking



Strathnairn Street, SE1

The house has a wonderful sense of space and is flooded with light due to its southerly aspect and conservatory.

On the ground floor is a substantial main reception room, which leads through to the conservatory and the garden, which is decked with low maintenance raised beds. The kitchen is also to the back of the house, overlooking the garden.

On the floor above are two double bedrooms, with ample room for storage, a single bedroom currently used as a study, and the family bathroom, as well as access to a large boarded loft.

The house additionally benefits from solar panels and an off-street parking space. There also remains significant potential for extension, subject to planning, both to the rear and into the loft.



Strathnairn Street, London, SE1

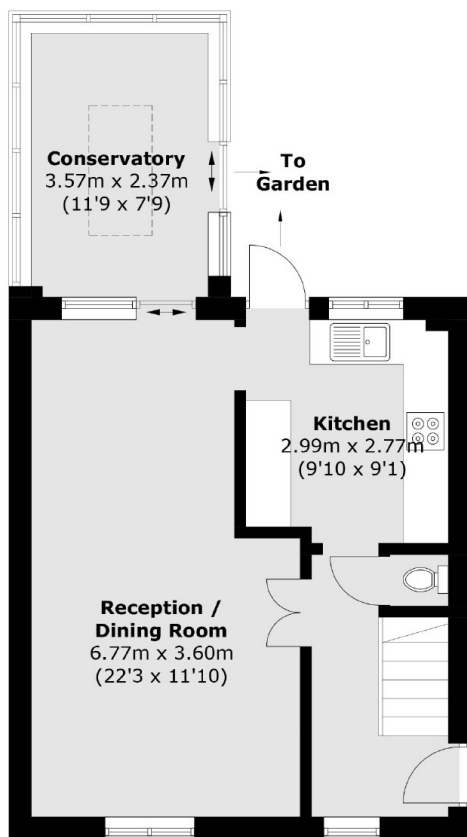

Ground Floor

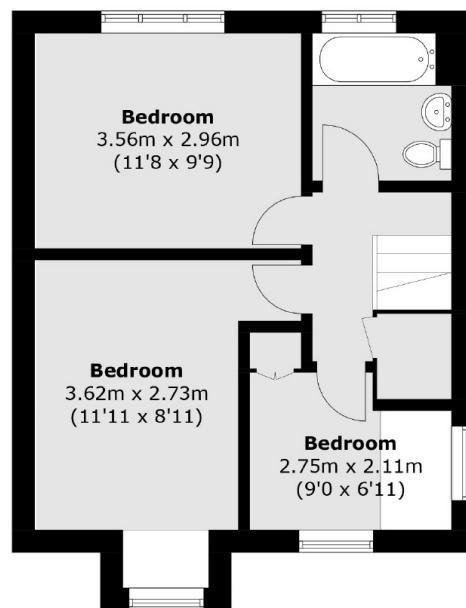

First Floor

Total area (approx.): 83.9 sq. m (903.1 sq. ft)