



Strathnairn Street, SE1

£750 Per week

Dexters



Strathnairn Street, SE1

An incredibly well presented end of terrace three bedroom house with a large open plan living room, a high spec modern kitchen and conservatory dining area looking on to the south facing garden.

An incredibly well presented end of terrace three bedroom house with a large open plan living room, a high spec modern kitchen and conservatory dining area looking on to the south facing garden.

Strathnairn Street is a quiet residential street, tucked back from Southwark Park Road and St James's Road, adjacent to Thoburn Square, within easy reach of both Bermondsey Underground & South Bermondsey Station.

Features

- Three Bedrooms
- South Facing Garden
- Plenty Of Storage
- Open Plan Living
- Modern Kitchen
- Parking



Strathnairn Street, London, SE1

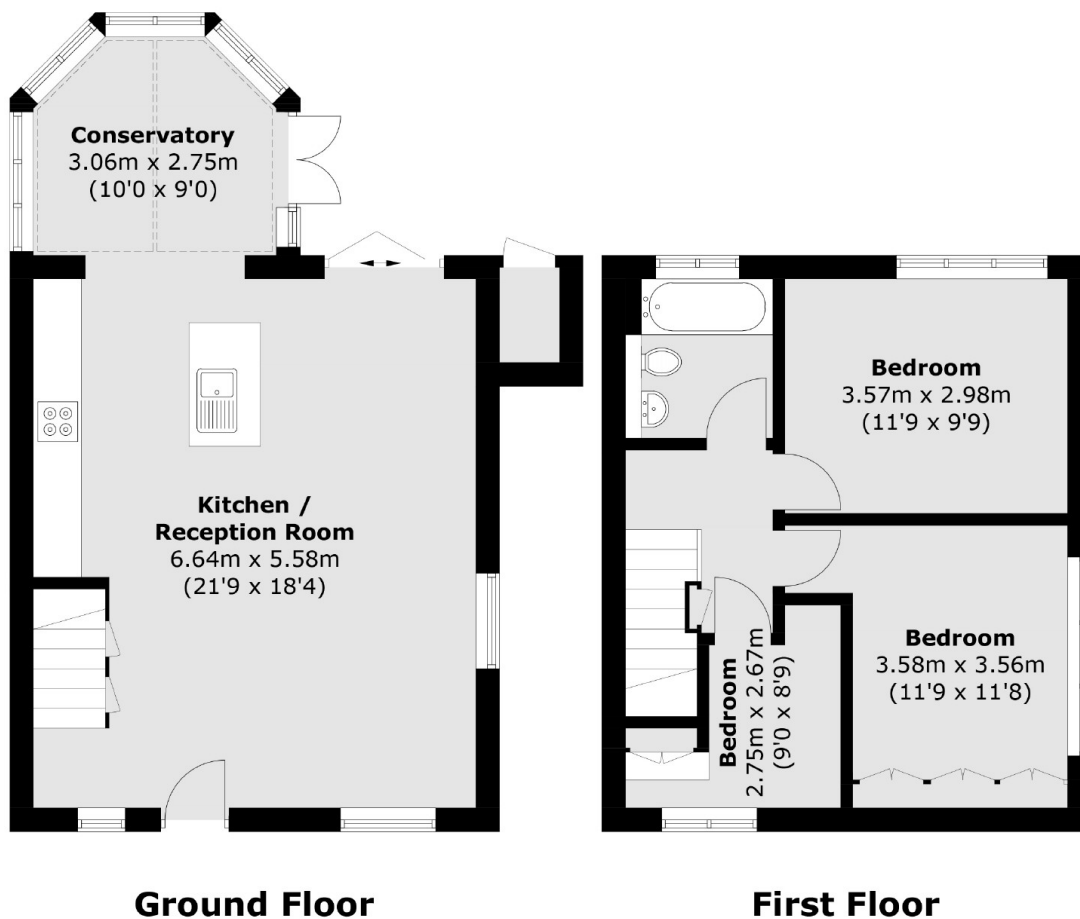

Total area (approx.): 82.8 sq. m (891.3 sq. ft)
External Cupboard: 0.9 sq. m (9.7 sq. ft)