



Great Dover Street, SE1

£646 Per week

This newly refurbished two bedroom apartment situated two minutes away from Borough Station in a private development with on site concierge and Gym. Both bedrooms are double rooms and there is wood floor throughout.

Well located within a quarter of a mile of Borough Tube station and Borough Market and easy access to the City and London's South Bank.

Features

- Two Bedrooms
- Open Plan Living
- Newly Refurbished
- Wooden Flooring
- On Site Concierge
- Residents Gym

Great Dover Street, London, SE1

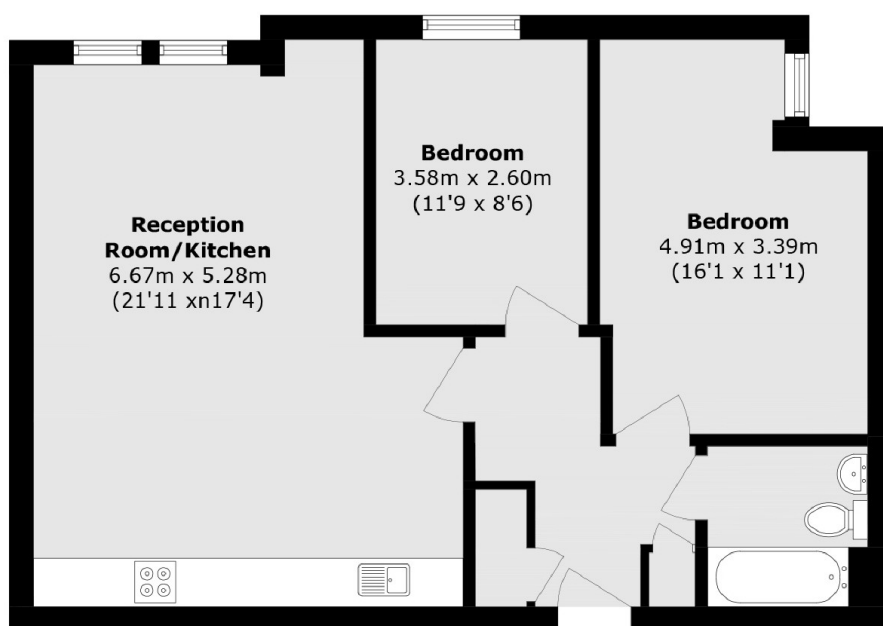

Total area (approx.): 69.2 sq. m (744.8 sq. ft)