



## St. Saviours Estate, SE1

### £450,000

With stunning views of the City and Tower Bridge, this two double bedroom flat is immaculately presented and boasts a large kitchen, separate living space, modern bathroom, ample storage and private balcony.

Thetford House is perfectly located equidistant from either Bermondsey and London Bridge stations, only 0.6 miles away. Maltby Street Market is only a stones throw away with a plethora of shops and bistros and cafés on Bermondsey Street too.

### Features

- Two Double Bedrooms
- Chain Free
- Incredible Location
- Private Balcony
- Great Views
- Offers Over £450,000

# St. Saviours Estate, London, SE1

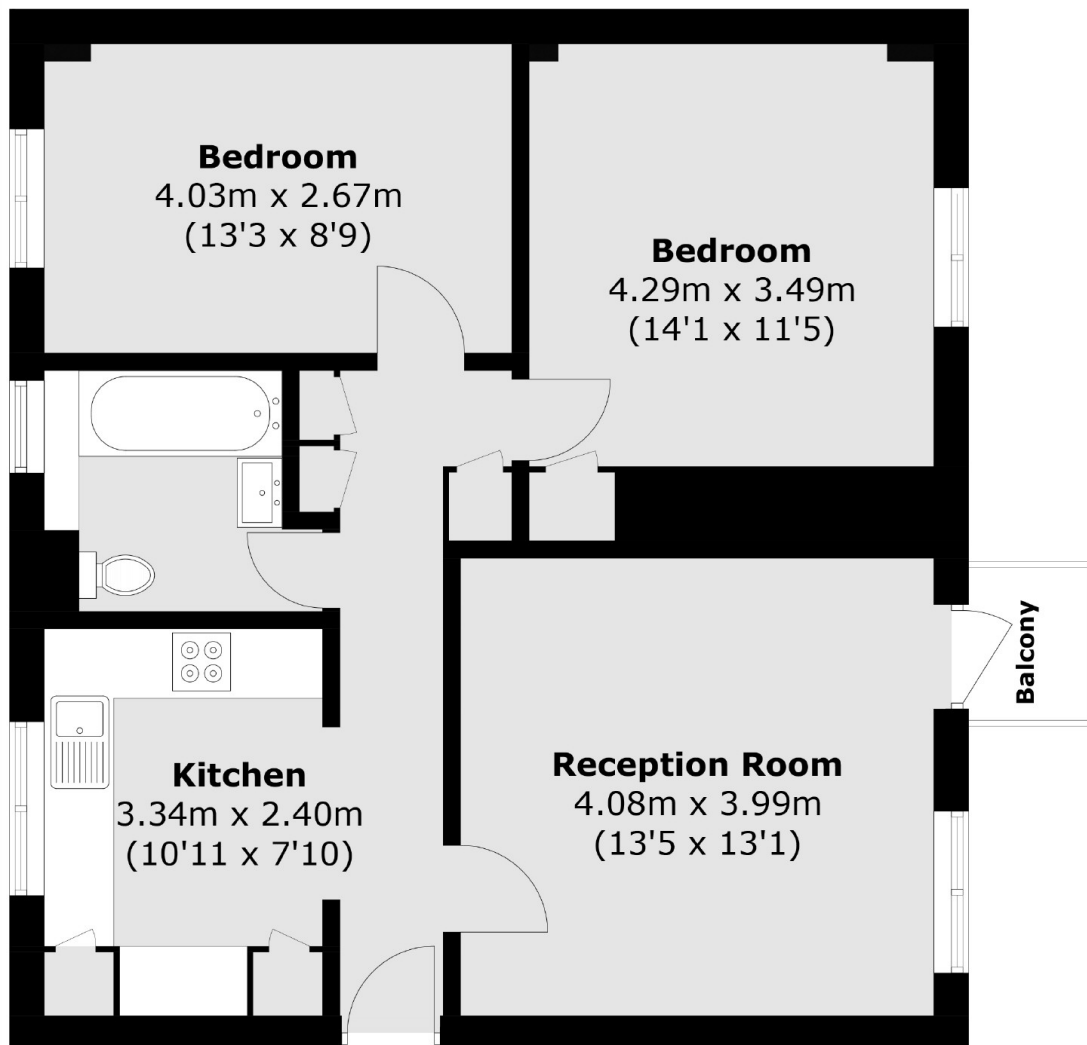

Total area (approx.): 64.6 sq. m (695.3 sq. ft)  
Balcony : 1.4 sq. m (15.1 sq. ft)