



Webber Street, SE1

£435,000

A highly desirable apartment with a spacious open plan kitchen and living room, a generous double bedroom, ample storage, a modern bathroom, 24 hour concierge and communal courtyard.

Webber Street is found in the heart of SE1, between Borough, Southwark and London Bridge stations, with easy access to the Southbank, Borough Market, various other attractions including the Tate Modern, Globe Theatre, and many schools.

Features

- One Double Bedroom
- 24 Hour Concierge & Courtyard
- Lift Access & Secure Entry
- Secure Bicycle Parking
- EWS1 A1 Compliant
- Chain Free Sale



Webber Street, SE1

The apartment benefits from excellent natural light thanks to full height windows in every room. The main living space opens out onto the balcony, overlooking the communal courtyard.

The bedroom is a very good size, with ample space and built-in storage. The main living space is a great size, with a fully fitted kitchen and ample room for dining and a separate seating area.

MyBase is a very well kept and secure development with a 24 hour concierge service, residents' bike storage and a large communal courtyard. The building has recently undergone extensive works to the cladding and has a EWS1 A1 rating.



Webber Street, London, SE1

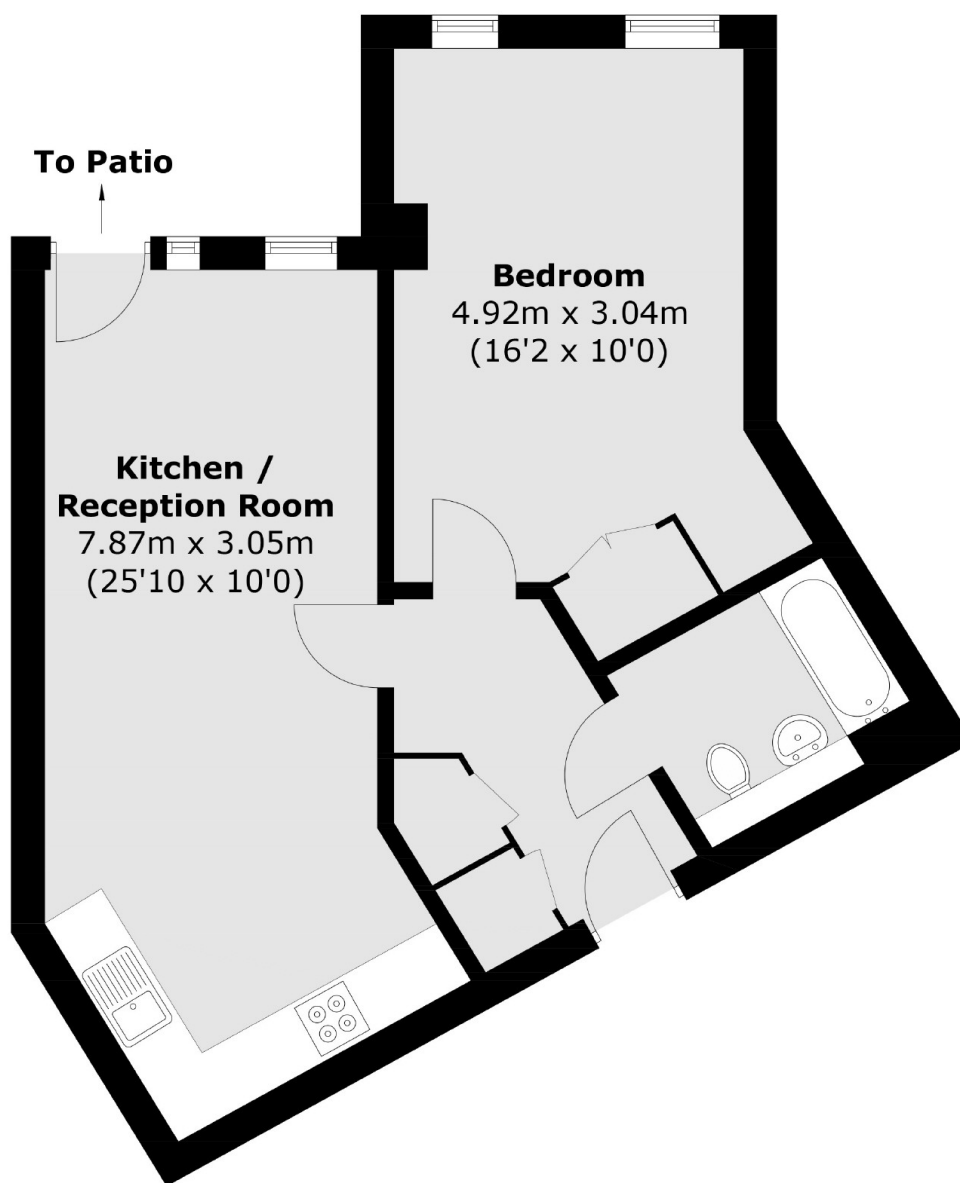

Total area (approx.): 50.8 sq. m (546.8 sq. ft)

Dexters

London Bridge
54 Borough High Street
London
SE1 1XL
Sales
020 7650 5 100

Energy Rating: . We aim to make our particulars both accurate and reliable. However they are not guaranteed; nor do they form part of an offer or contract. If you require clarification on any points then please contact us, especially if you're traveling some distance to view. Please note that appliances and heating systems have not been tested and therefore no warranties can be given as to their good working order.

 **RICS** | Regulated
Estate Agent
and Letting Agent

dexters.co.uk