



Bermondsey Wall West, SE16

£450,000

Situated within a gated riverside development, this one double bedroom flat is in excellent condition and has a open plan kitchen living space, modern bathroom, ample storage and allocated parking.

Located just 0.3 miles from Bermondsey station and 0.7 miles from London Bridge station, River View Heights offers excellent transport links and is surrounded by shops, cafés, trendy food markets and restaurants.

Features

- One Double Bedroom
- Excellent Condition
- Light and Airy
- Secure Parking
- Porter Facilities
- Riverside Development
- Offers over £450,000

Bermondsey Wall West, London, SE16

Fifth Floor

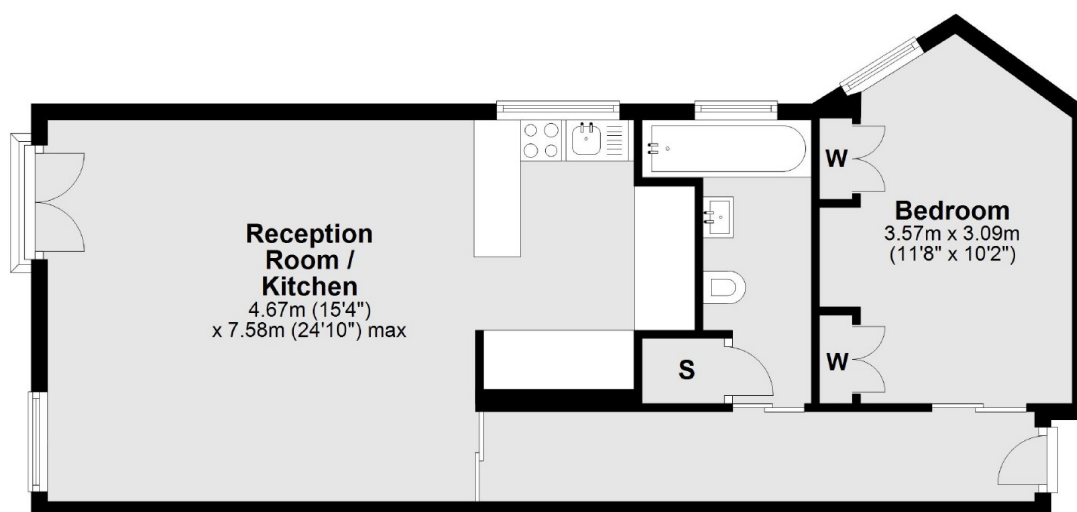

Total area: approx. 59.6 sq. metres (641.1 sq. feet)