



Rowcross Street, SE1

£375,000

OIEO £400,000 - An attractive over 700 sq ft second floor apartment with an open plan kitchen and living room, two generous double bedrooms and two bathrooms, plus ample storage and a Juliet balcony. Lift access & secure entry.

Rowcross Street is enviably located, set back off the Old Kent Road, with its numerous amenities. Burgess Park is a few moments away with transport links via Elephant & Castle, Bermondsey & South Bermondsey Stations and major bus routes nearby.

Features

OIEO - £400,000
Modern Development
Two Double Bedrooms
Secure Entry
Juliet Balcony
Open Plan Living
Valid EWS1 Form

Rowcross Street,
London, SE1

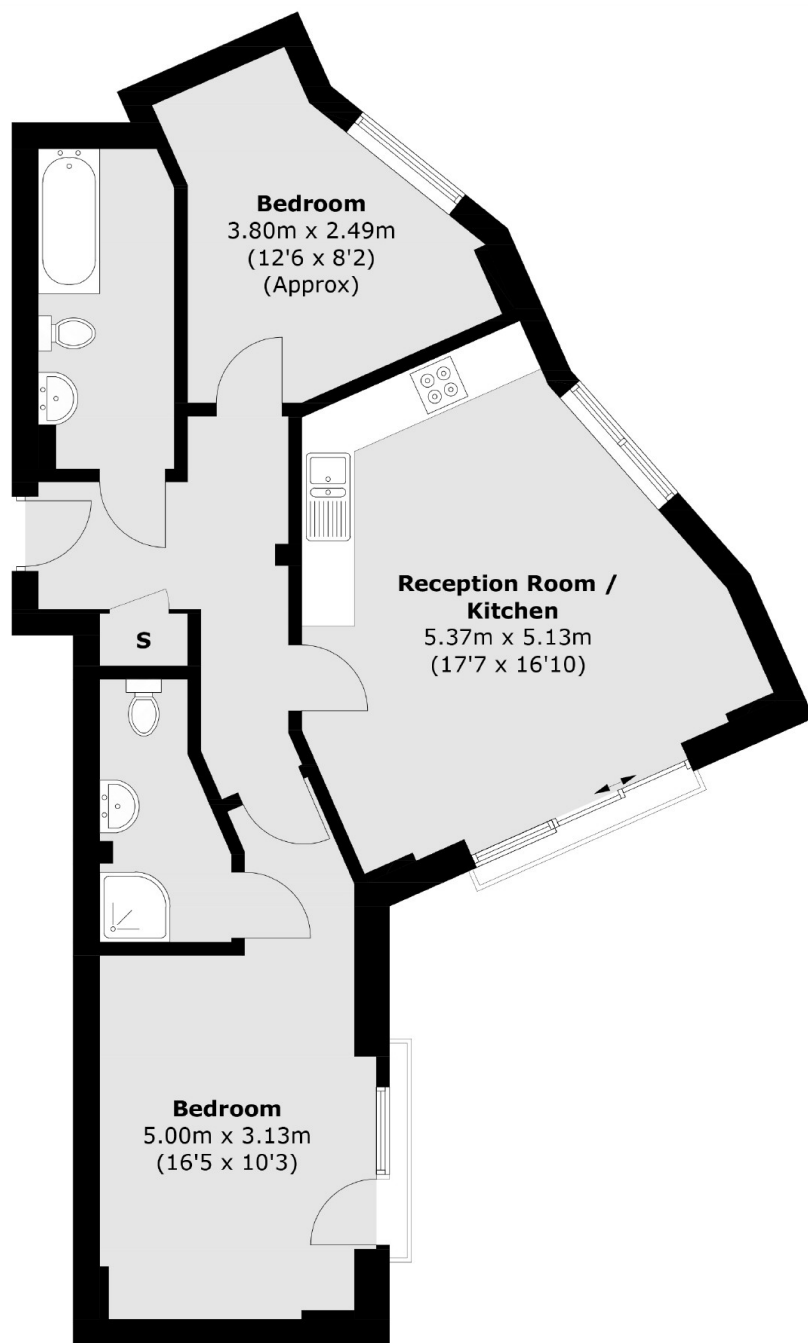

Second Floor

Total area (approx.): 67.5 sq. m (726.6 sq. ft)
Balcony area (approx.): 1.0 sq. m (10.8 sq. ft)

Dexters

London Bridge
54 Borough High Street
London
SE1 1XL
Sales
020 7650 5 100

Energy Rating: B. We aim to make our particulars both accurate and reliable. However they are not guaranteed; nor do they form part of an offer or contract. If you require clarification on any points then please contact us, especially if you're traveling some distance to view. Please note that appliances and heating systems have not been tested and therefore no warranties can be given as to their good working order.

 **RICS** | Regulated
Estate Agent
and Letting Agent

dexters.co.uk