



## Rowcross Street, SE1

£400,000

An attractive over 700 sq ft second floor apartment with an open plan kitchen and living room, two generous double bedrooms and two bathrooms, plus ample storage and a Juliet balcony. Lift access & secure entry.

Rowcross Street is enviably located, set back off the Old Kent Road, with its numerous amenities. Burgess Park is a few moments away with transport links via Elephant & Castle, Bermondsey & South Bermondsey Stations and major bus routes nearby.

### Features

- Modern Development
- Two Double Bedrooms
- Secure Entry & Lift Access
- Juliet Balcony
- Open Plan Living
- Valid EWS1 Form

Rowcross Street,  
London, SE1

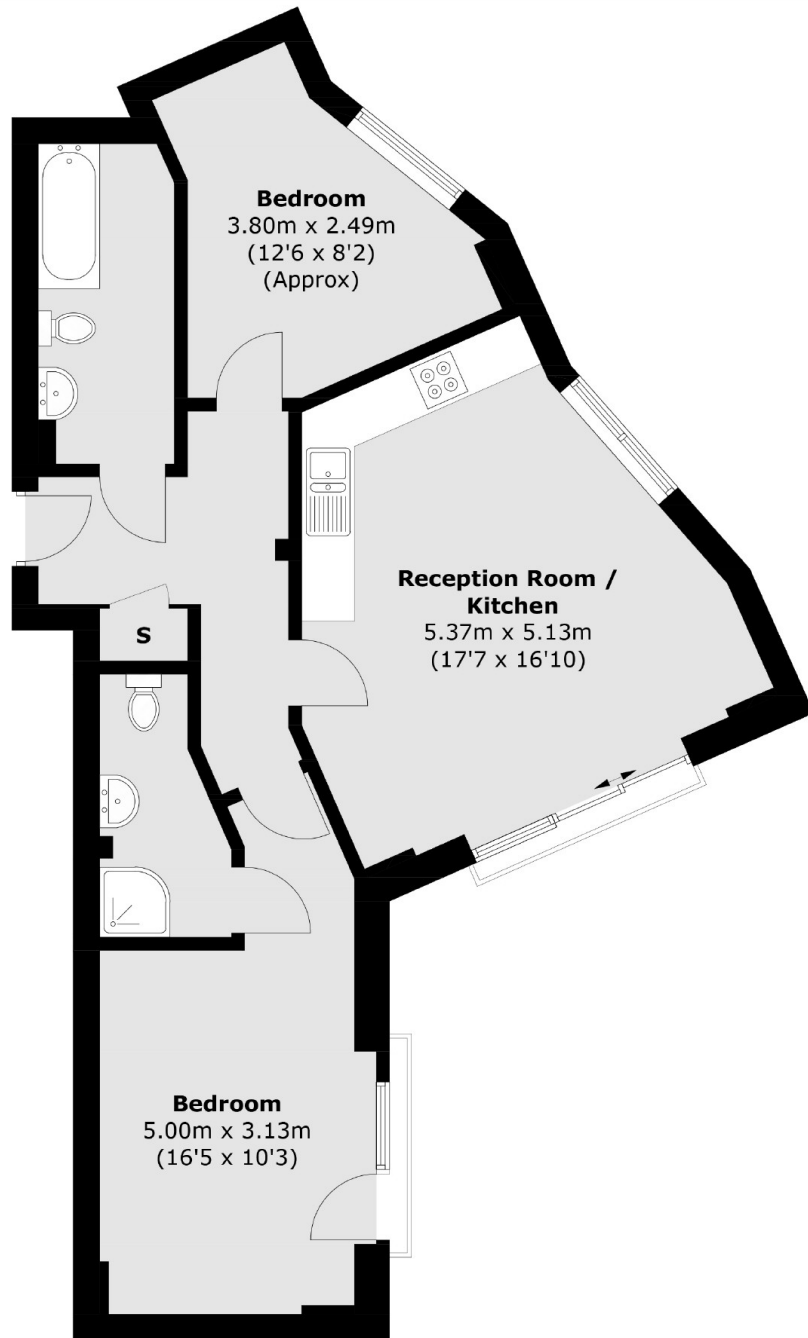

### Second Floor

Total area (approx.): 67.5 sq. m (726.6 sq. ft)  
Balcony area (approx.): 1.0 sq. m (10.8 sq. ft)

**Dexters**

London Bridge  
54 Borough High Street  
London  
SE1 1XL

Sales  
020 7650 5 100

Energy Rating: B. We aim to make our particulars both accurate and reliable. However they are not guaranteed; nor do they form part of an offer or contract. If you require clarification on any points then please contact us, especially if you're traveling some distance to view. Please note that appliances and heating systems have not been tested and therefore no warranties can be given as to their good working order.

 **RICS** | Regulated  
Estate Agent  
and Letting Agent

dexters.co.uk