



Rainbow Quay, SE16

£375,000

With stunning views of Canary Wharf and the water, this one double bedroom flat boasts a large living space, separate kitchen, large bedroom, secure parking space, a share of the freehold and ample storage.

Rainbow Quay is located 0.6 miles from Surrey Quays station and 0.7 miles from Canada Water station. The Thames Clipper is also moments away offering excellent transport links to all of London.

Features

- One Double Bedroom
- Water Views
- Share Of The Freehold
- Great Transport Links
- Secure Allocated Parking
- No Chain

Rainbow Quay, London, SE16

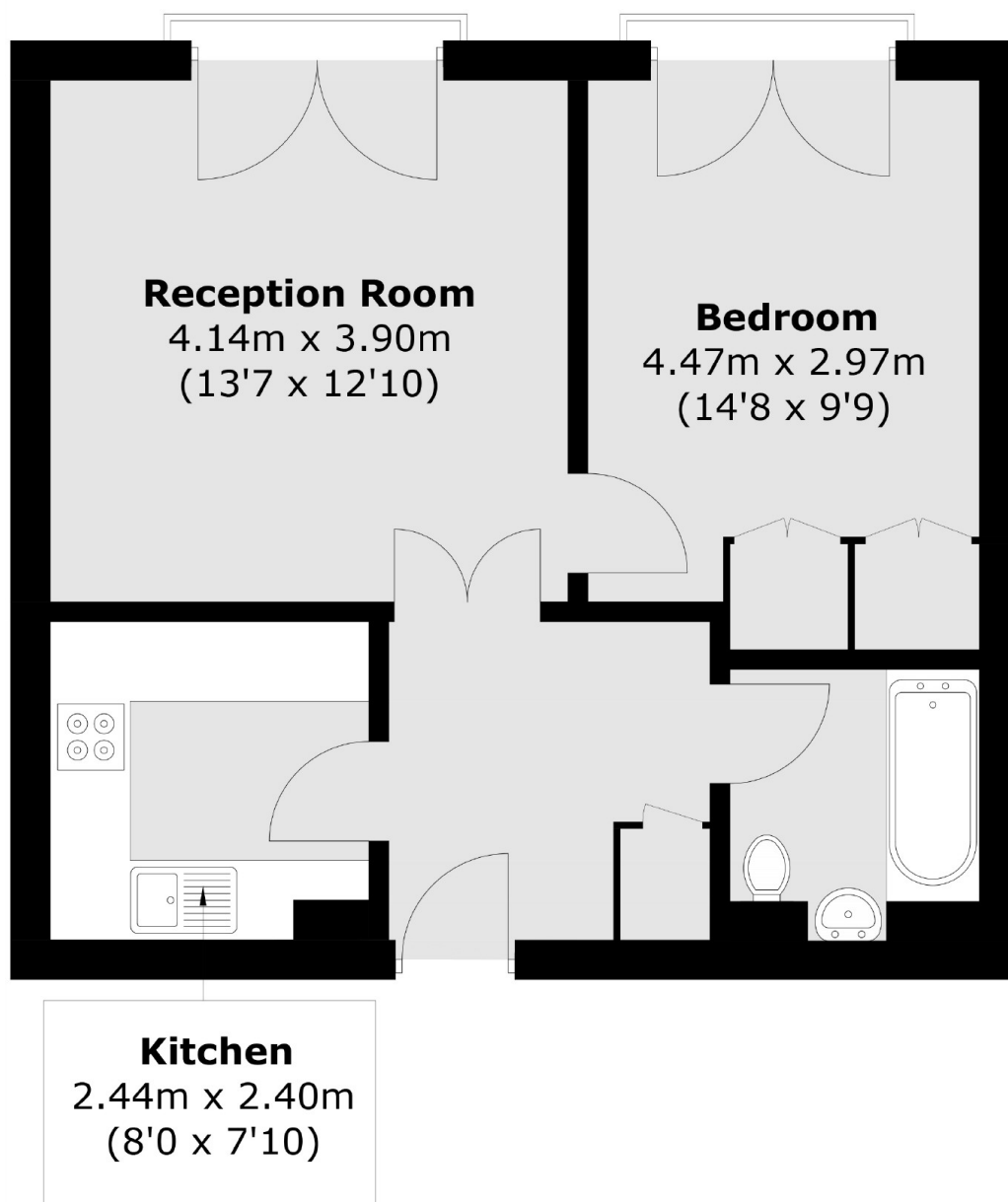

Total area (approx.): 46.1 sq. m (496.2 sq. ft)