



## Green Walk, SE1

£750,000

A highly attractive, Victorian freehold house, requiring refurbishment, with a very large double reception room, a separate kitchen leading out to a private rear garden, plus two generous double bedrooms, a family bathroom and loft storage. On-street, permit parking is available.

Green Walk is a very centrally located residential road, moments from Bermondsey Street, with London Bridge, Borough Market & the Southbank just beyond. Adjacent is the iconic former Hartley's Jam Factory.

### Features

Victorian Freehold House  
Two Storeys  
Two Double Bedrooms  
Extension Potential STPP  
On-street Permit Parking  
Chain Free

Green Walk,  
London, SE1

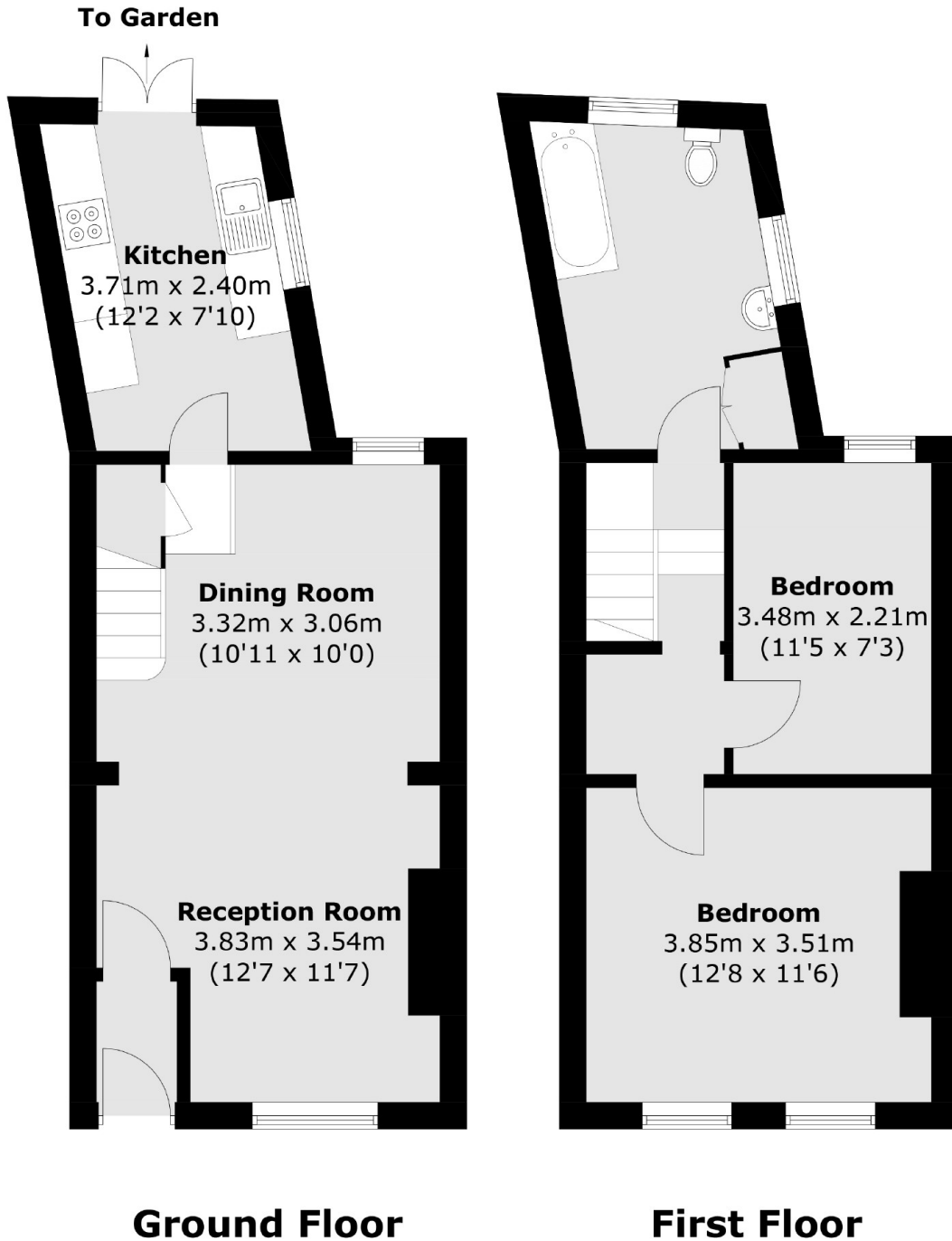

Total area (approx.): 73.0 sq. m (785.8 sq. ft)