



## The Grange, SE1

£450,000

Situated within this sought after development, this one double bedroom flat is in excellent condition and boasts a large open plan kitchen- living space, private balcony, concierge facilities and communal gardens.

Corio House is moments from the vibrant Maltby Street Market and Bermondsey Street and is surrounded by artisan shops, cafés and delis. Bermondsey station is only 0.6 miles away and London Bridge is 0.8 miles away.

### Features

- One Double Bedroom
- Private Balcony
- 24/7 Concierge
- Secure Development
- Fantastic Condition
- Bike Storage

# The Grange, London, SE1

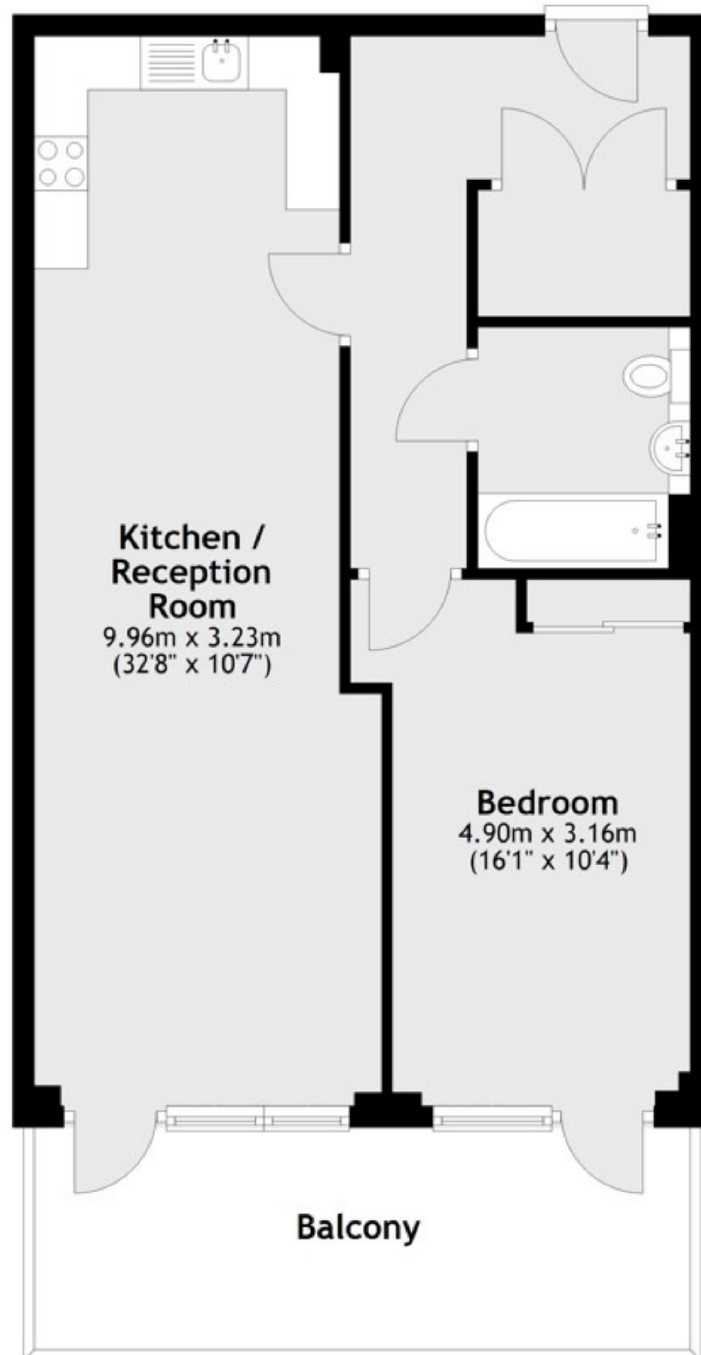

**Main area: Approx. 60.8 sq. metres (654.0 sq. feet)**  
Plus balconies, approx. 13.2 sq. metres (142.3 sq. feet)

**Dexters**

London Bridge  
54 Borough High Street  
London  
SE1 1XL  
Sales  
020 7650 5 100

Energy Rating: B. We aim to make our particulars both accurate and reliable. However they are not guaranteed; nor do they form part of an offer or contract. If you require clarification on any points then please contact us, especially if you're traveling some distance to view. Please note that appliances and heating systems have not been tested and therefore no warranties can be given as to their good working order.

 **RICS** | Regulated  
Estate Agent  
and Letting Agent

[dexters.co.uk](http://dexters.co.uk)