



Southwark Bridge Road, SE1

£530 Per week

Large 660 sq ft + modern furnished 1 bedroom apartment in sought after development close to Borough High Street. The apartment features wood flooring and a private balcony.

Close to Borough Station.

Features

- Balcony
- 600sq ft +
- Furnished
- Wood Flooring
- Large Living room
- Close to Borough High Street

Southwark Bridge Road, London, SE1

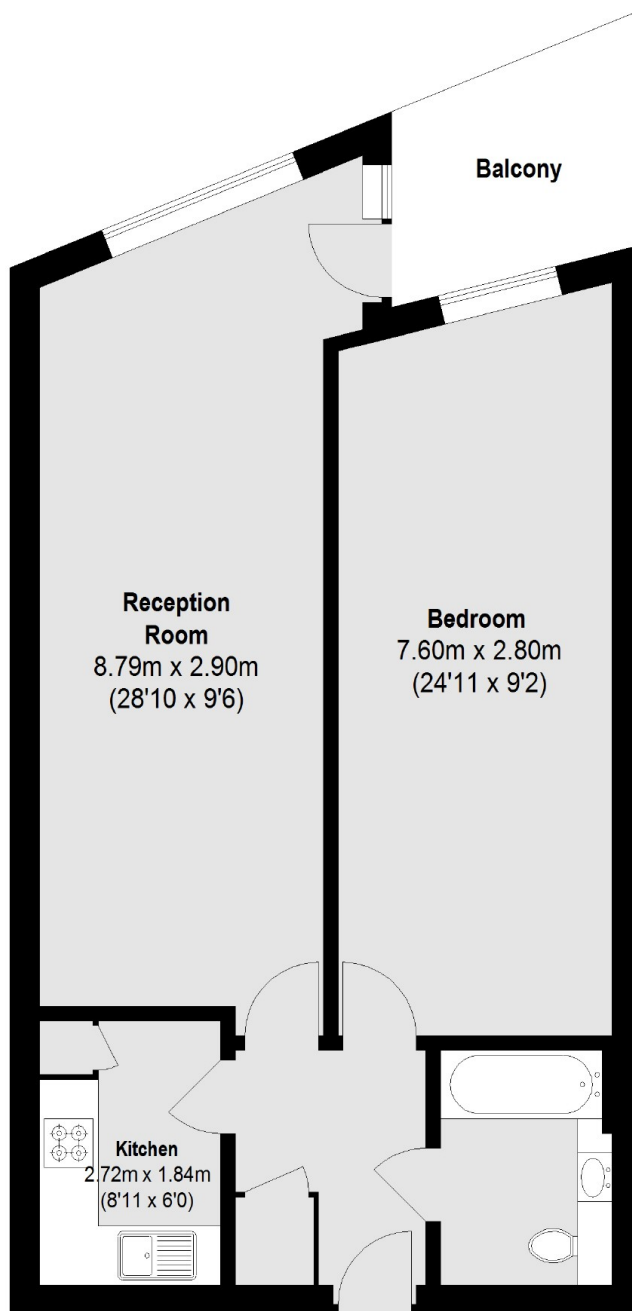

Second Floor

Total area (approx.): 61.55 sq. m (663 Sq. ft)
Balcony: 5.62 sq. m (60 Sq. ft)