



Bermondsey Wall West, SE16

£425,000

Situated moments from the river, this one double bedroom flat is immaculately presented and boasts a large living space, modern kitchen and bathroom, private balcony, allocated parking space, ample storage and is being sold chain free.

Located just 0.3 miles from Bermondsey station and 0.7 miles from London Bridge station, Springview Heights offers excellent transport links and is surrounded by shops, cafés, trendy food markets and restaurants.

Features

- One Double Bedroom
- Excellent Condition
- Chain Free
- Allocated Parking Space
- Fantastic Riverside Location
- Private Balcony

Bermondsey Wall West, London, SE16

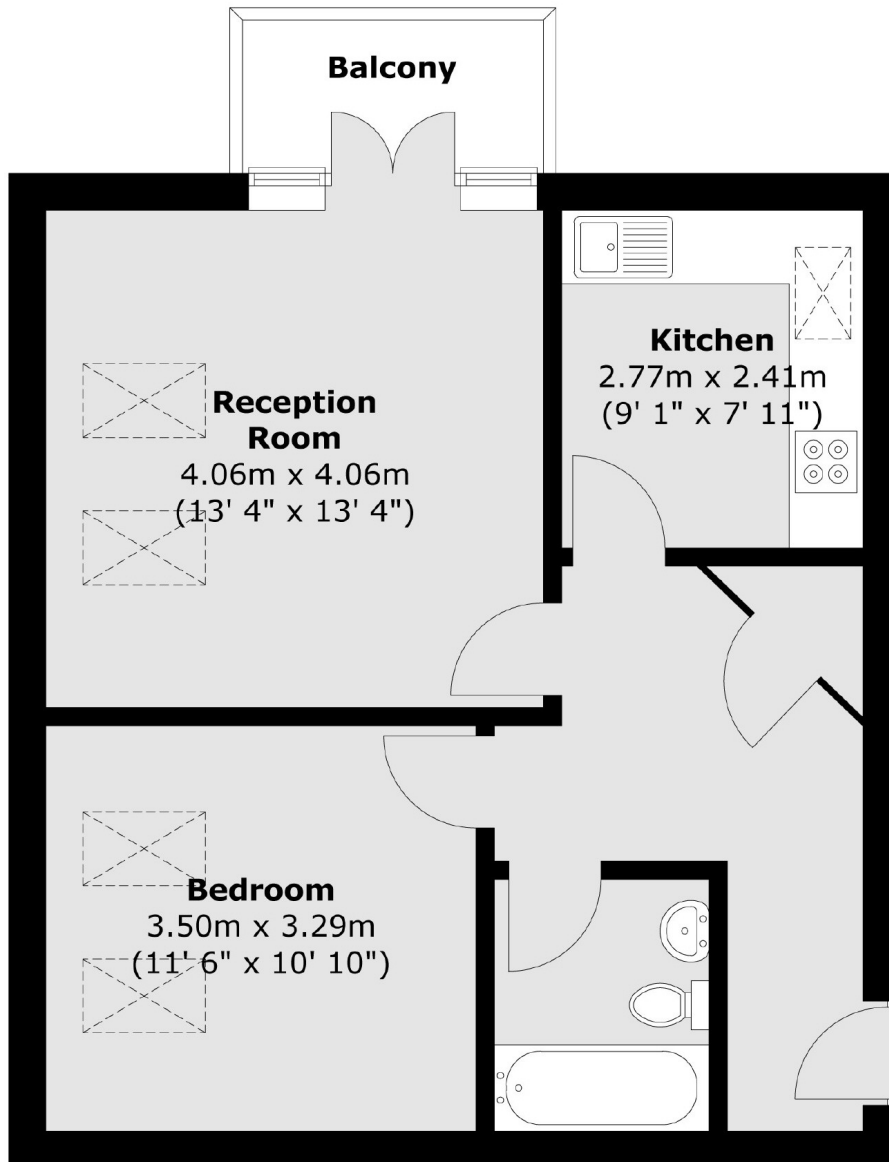

Total area (approx.) : 50.3 sq. m (541 sq. ft)
Total balcony area (approx.) : 2.7 sq. m (29 sq. ft)