



## Lancaster Street, SE1 £550,000

A very spacious 837 sq ft, west-facing flat, with three double bedrooms, a spacious living room, leading out onto a private balcony and overlooking the communal gardens, a large kitchen-diner, family bathroom and WC.

Lancaster Street is incredibly well located, tucked back off Blackfriars Road, moments from Southwark, Waterloo and Blackfriars Stations, with the Cut, Lower Marsh and the South Bank all on your doorstep.

### Features

- West-Facing
- Three Double Bedrooms
- Large Kitchen-Diner
- Separate Living Room
- Private Balcony
- Very Central Location

Lancaster Street,  
London, SE1

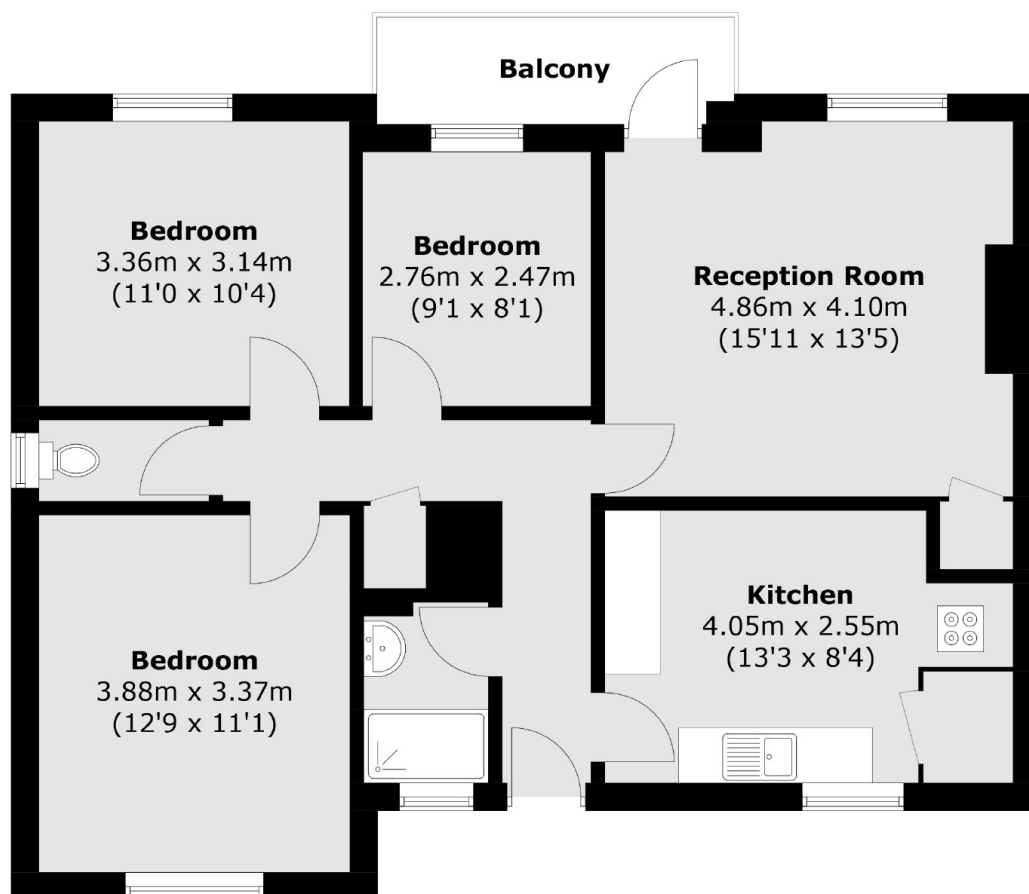

Total area (approx.): 77.8 sq. m (837.4 sq. ft)  
Balcony: 4.5 sq. m (48.4 sq. ft)