



## Needleman Street, SE16

£600,000

Situated on the first floor of this sought after development, this two double bedroom flat is immaculately presented and boasts a large open plan kitchen/ living area, private balcony, two modern bathrooms, parking space and concierge and gym facilities.

Vancouver House is enviably located 50 meters from Canada Water station and is surrounded by shops, café's, delis and restaurants. The river is also moments away along with the historic Tower Bridge.

### Features

- Two Double Bedrooms
- Two Bathroom
- Excellent Condition
- Private Balcony
- Concierge & Gym Facilities
- Parking

Needleman Street,  
London, SE16

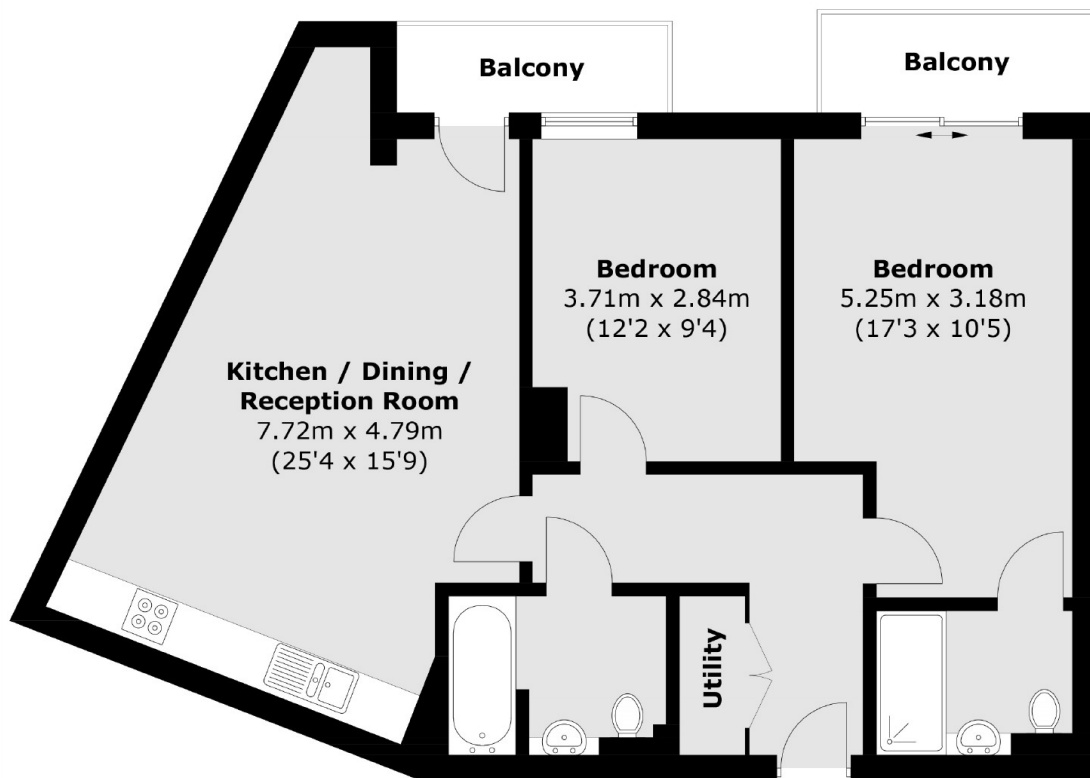

Total area (approx.): 73.5 sq. m (791.1 sq. ft)  
Balcony (approx.): 6.6 sq. m (71.0 sq. ft)

**Dexters**

London Bridge  
54 Borough High Street  
London  
SE1 1XL  
Sales  
020 7650 5 100

Energy Rating: B. We aim to make our particulars both accurate and reliable. However they are not guaranteed; nor do they form part of an offer or contract. If you require clarification on any points then please contact us, especially if you're traveling some distance to view. Please note that appliances and heating systems have not been tested and therefore no warranties can be given as to their good working order.

 **RICS** | Regulated  
Estate Agent  
and Letting Agent

dexters.co.uk