



## Odessa Street, SE16

£350,000

Offering spectacular views of the river and Canary Wharf, this one double bedroom flat is in excellent condition and has an open plan kitchen/ living space, private balcony, allocated parking, concierge, gym and swimming pool facilities.

Located less than a mile from Canada Water station and Surrey Quays Station, New Caledonian Wharf offers great links to Canary Wharf and The City. The development is also surrounded by riverside restaurants and pubs.

### Features

- One Double Bedroom
- Private Balcony
- Stunning Views
- On Site Facilities
- Allocated Parking
- Gated Development
- Offers in excess of £350,000

# Odessa Street, London, SE16

## Fourth Floor

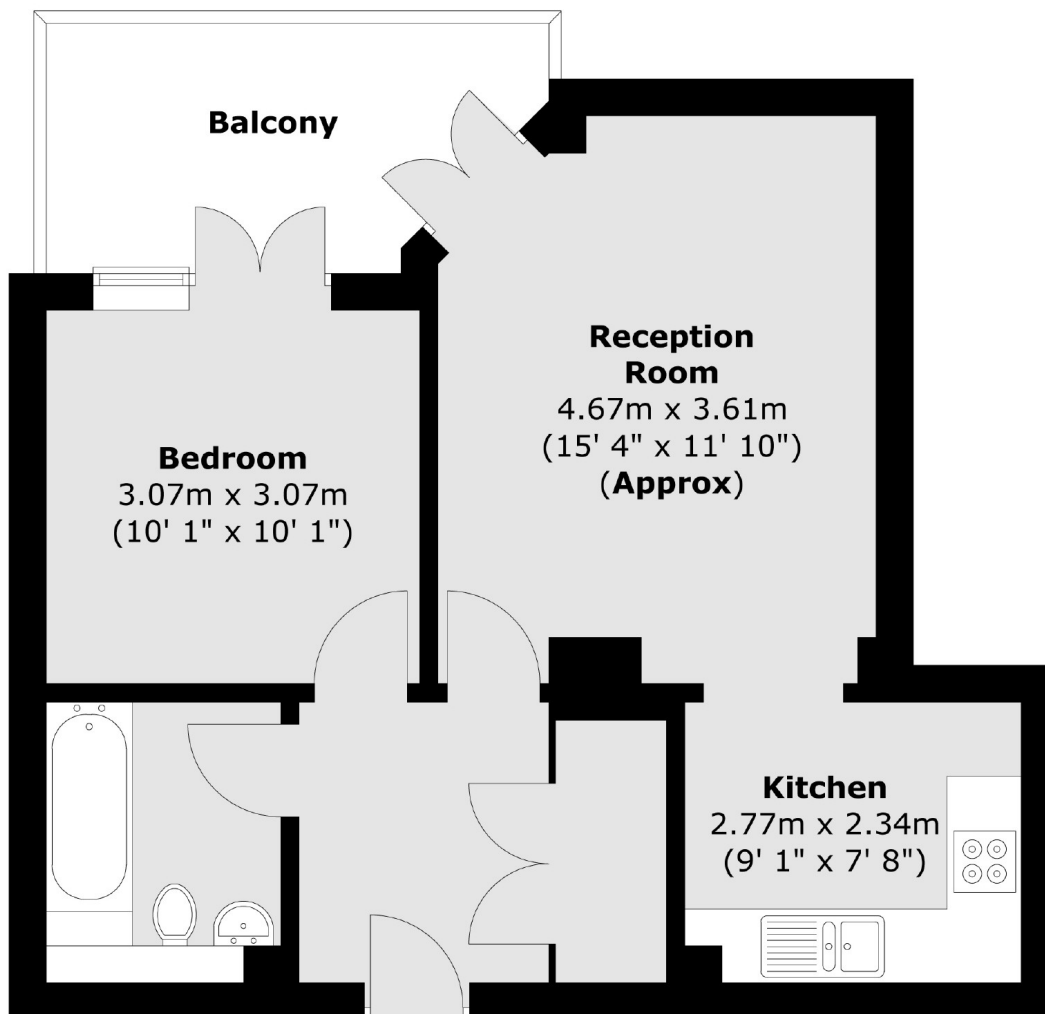

Total area (approx.) : 46.3 sq. m (498 sq. ft)  
Total balcony area (approx.) : 7.5 sq. m (81 sq. ft)