



Maidstone Buildings Mews, SE1

£5,000 Per week

Beautifully finished apartment comprising two great sized bedroom with a lovely Juliette balcony in the primary, a spacious open plan kitchen/reception and a sleek three-piece bathroom suite.

Borough High Street is incredibly well located, tucked just back from Borough Market. London Bridge Station, the Thames, Bank Side and the Shard are all very close by with numerous amenities and other attractions.

Features

- Short Let
- Fantastic Central Location
- 2 Bedrooms
- Concierge
- Juliette Balcony
- Borough Market

Maidstone Buildings Mews, London, SE1

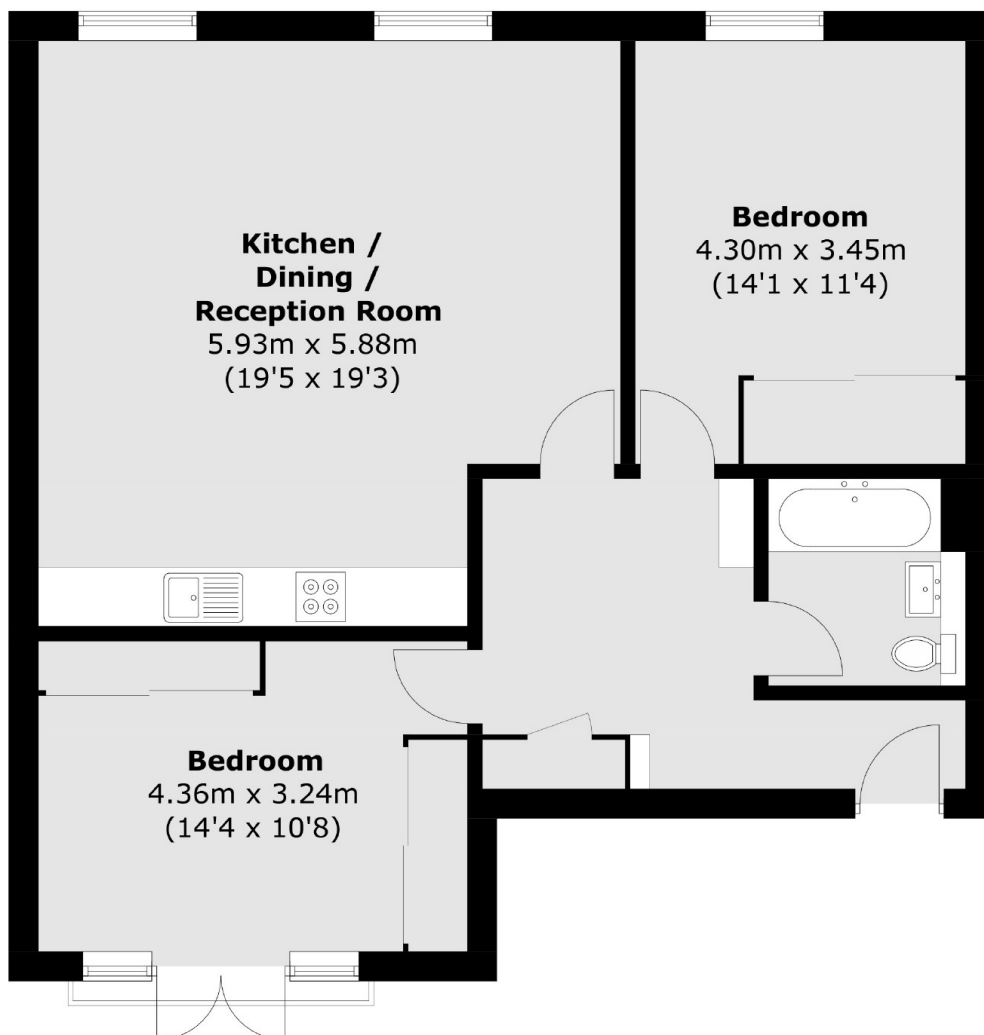

Total area (approx.): 79.0 sq. m (850.3 sq. ft)