



Cadet Drive, SE1

£325,000

A highly attractive, and recently redecorated, first floor flat with a bright south-facing living room and a separate eat-in kitchen, a generous double bedroom, ample storage and a three piece bathroom, plus secure parking.

Cadet Drive is a quiet residential close, tucked back off Lynton Road, with numerous local amenities nearby. Bermondsey Underground and South Bermondsey Station are both less than a mile away, with excellent bus links too.

Features

- First Floor Flat
- South Facing
- Separate Kitchen
- Ample Storage
- Secure Parking
- Chain Free Sale

Cadet Drive, London, SE1

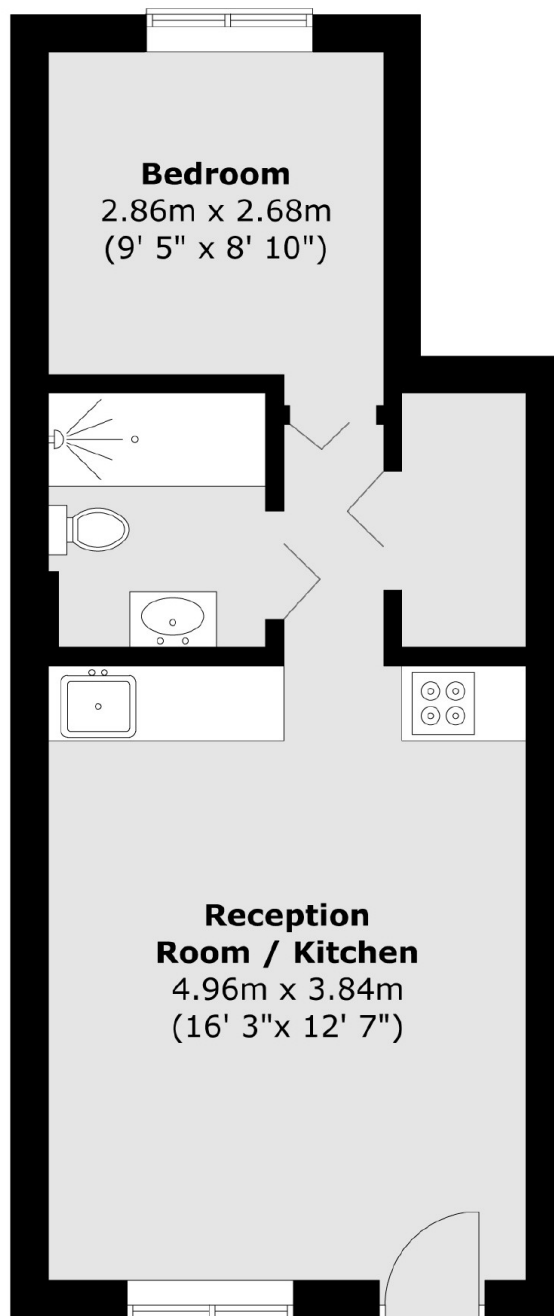

Total area (approx.) : 35.1 sq. m (378 sq. ft)