



## Marine Street, SE16

£575,000

Offering spectacular views of the London Skyline, this seventh floor, two double bedroom flat is in immaculate condition and has a large open plan kitchen living space, wrap around balcony, ample storage and lots of natural light.

Eyot House is only 0.2 miles from Bermondsey station. Shad Thames, London Bridge, Maltby Street Market and a wide range of shops, cafés, delis and restaurants are all close by.

### Features

- Two Double Bedrooms
- Spectacular Views
- Immaculate Condition
- Large Private Balcony
- Incredible Location
- North and West Facing

# Marine Street, London, SE16

## Seventh Floor

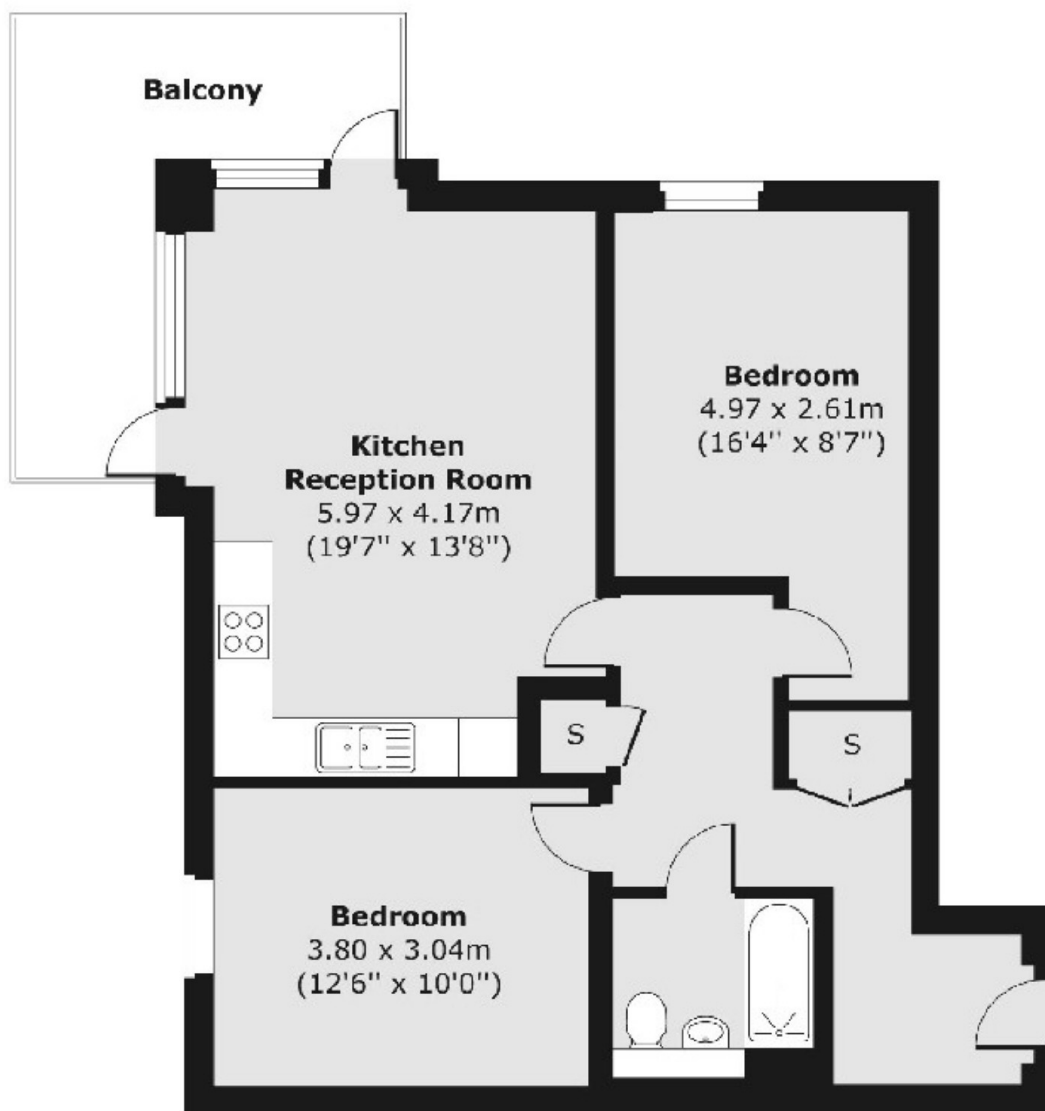

Total area (approx.) 64.44 sq. m (694 sq. ft)  
Balcony area (approx.) 10.21 sq. m (110 sq. ft)