



Sun Passage, SE16

£380,000

Situated in this sought after development, is a one double bedroom flat, on the 6th floor, is in fantastic condition, with hard wood floors, and has a large open plan kitchen living space, private balcony, ample storage and lots of natural light. Chain free sale.

Eyot House is only 0.2 miles from Bermondsey station. Shad Thames, London Bridge, Maltby Street Market and a wide range of shops, cafés and restaurants are all close by.

Features

- One Double Bedroom
- Excellent Condition
- Large Private Balcony
- Communal Bike Storage
- Fantastic Location
- Long Lease
- Chain free sale

Sun Passage, London, SE16

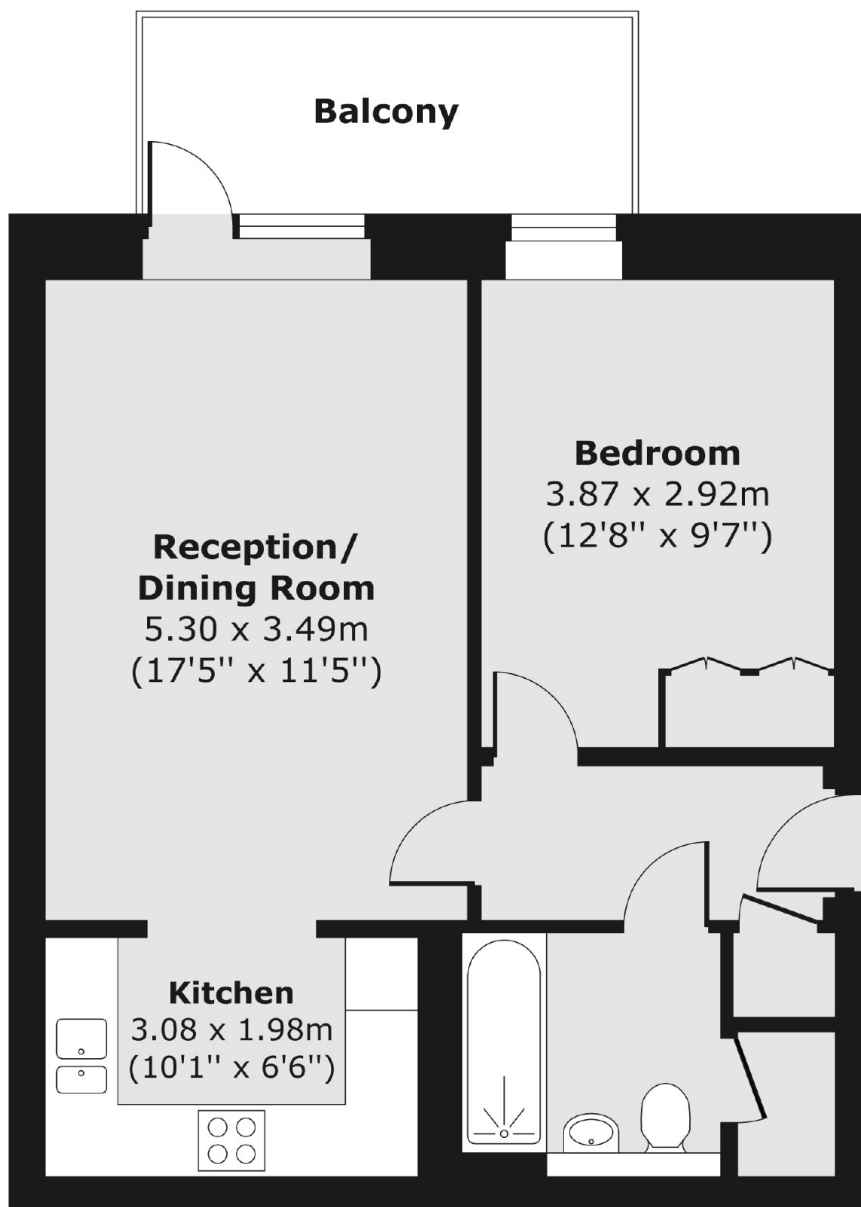

Total area (approx.) 48.99 sq. m (527 sq. ft)
Balcony area (approx.) 6.60 sq. m (71 sq. ft)