



Stead Street, SE17

£699,950

A beautifully bright and spacious two double bedroom top floor apartment in fantastic condition throughout. There is a fabulous open plan reception room with access onto a private balcony.

Stead Street is a fantastic location within a short walk of Elephant and Castle mainline and tube station (Northern & Bakerloo lines). There is a wide selection of local restaurants, coffee shops and bus routes close by.

Features

- Two Double Bedrooms
- Balcony
- Two Bathrooms
- Bright and Spacious
- Excellent Location
- Great Storage



Stead Street, SE17

The property is positioned on the fifth (top) floor and is brilliantly laid out with a spacious hallway with great storage. The large reception room has floor to ceiling windows drawing in lots of natural light and provides space for both living and dining areas. The sleek modern kitchen has plenty of work top space and combines brilliantly with the reception area. There is direct access onto a sunny private balcony with lovely open views over the park.

The master bedroom has built in wardrobes and a stylish ensuite bathroom. There is a second double bedroom, a family bathroom and a generous amount of storage throughout the property. This is a great development with well kept communal gardens and access to bike storage.



Stead Street, London, SE17

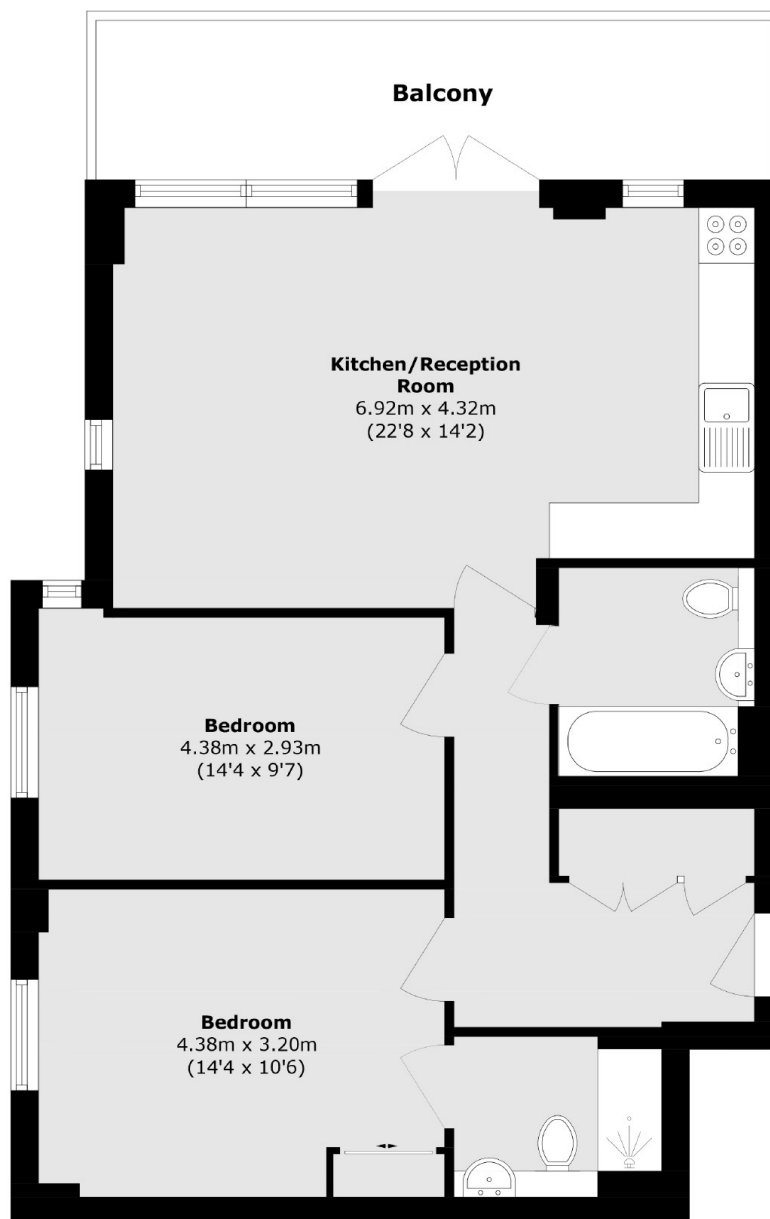

Total area (approx.): 77.0 sq. m (828.8 sq. ft)

Total area (approx.): 12.5 sq. m (134.5 sq. ft)

Dexters

Kennington
323 Kennington Road
London
SE11 4QE
Sales
0207 650 5102

Energy Rating: B. We aim to make our particulars both accurate and reliable. However they are not guaranteed; nor do they form part of an offer or contract. If you require clarification on any points then please contact us, especially if you're traveling some distance to view. Please note that appliances and heating systems have not been tested and therefore no warranties can be given as to their good working order.

 **RICS** | Regulated
Estate Agent
and Letting Agent

[dexters.co.uk](https://www.dexters.co.uk)