



Sutherland Square, SE17

£400,000

A gorgeous one bedroom first floor flat in exceptional condition throughout. Benefitting from a share of the freehold the property has a sociable living room with bespoke shelving and provides space for both living and dining areas. The separate kitchen packs a real punch with built in appliances and enjoys lovely views over gardens. The sumptuous bathroom has a shower over the bath and there is new triple glazing throughout.. Furthermore there is an allocated, covered parking space which is securely gated and there is access onto a beautiful garden which has been landscaped by the residents.

Sutherland Square is highly sought after, quietly tucked between Kennington and Burgess Park. There is easy access to transport with both Kennington Tube and Elephant and Castle stations just a short walk away. There are also many shops, bars and restaurants on its doorstep.

Features

- One Bedroom
- Share of Freehold
- Excellent Condition
- Wonderful Location
- Allocated Parking
- Communal Garden

Sutherland Square, London, SE17

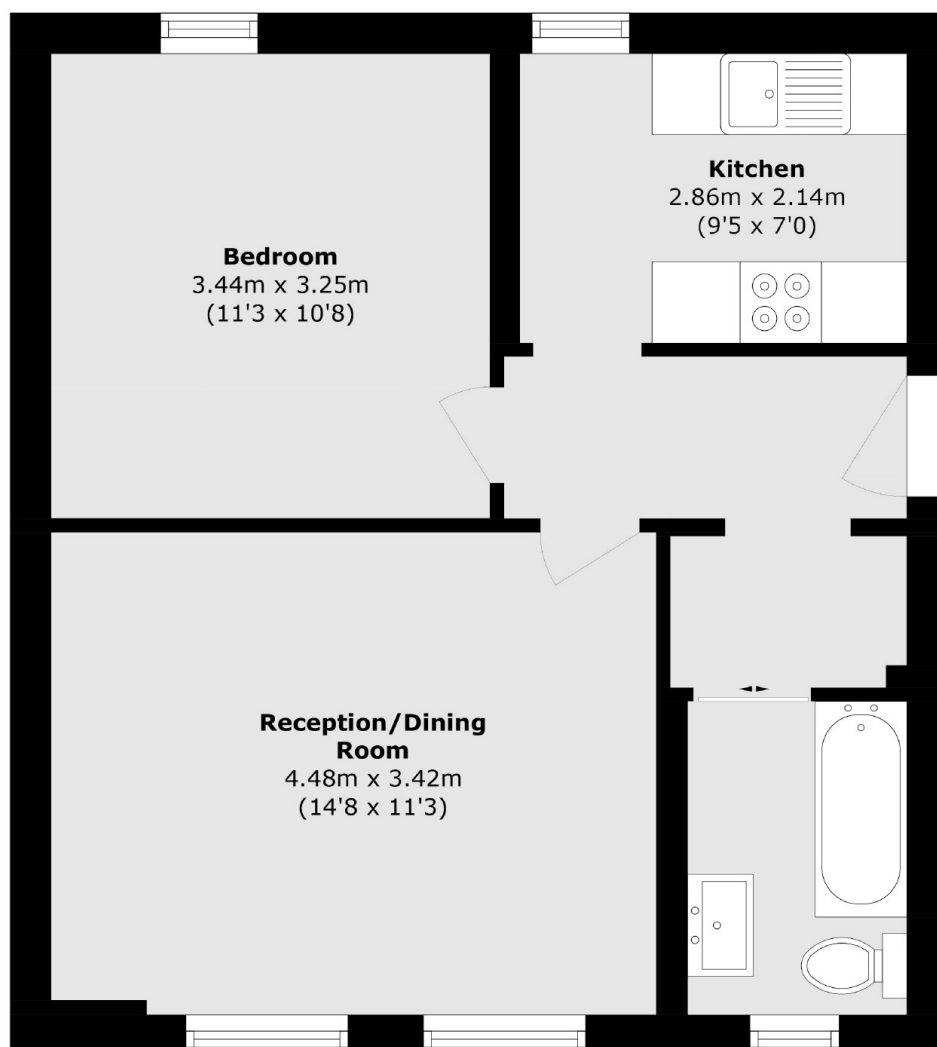

Total area (approx.): 45.0 sq. m (484.3 sq. ft)