



Bedser Close, SE11

£529,950

This beautifully presented two double bedroom, first-floor flat is in superb condition and features a recently renovated bathroom. The property offers a generous reception room that flows into a separate kitchen with plenty of worktop space. The property also benefits from access to a communal garden, an allocated gated parking space, a share of the freehold, and great storage throughout, making it a fantastic living space.

Bedser Close is a quiet private and gated close, with excellent access to both Vauxhall Mainline, Underground station (Victoria Line) and Oval tube station (Northern line).

Features

- Two Double Bedrooms
- Excellent Condition
- Great Location
- Communal Garden
- Gated Allocated Parking Space
- Freehold Share

Bedser Close, London, SE11

First Floor

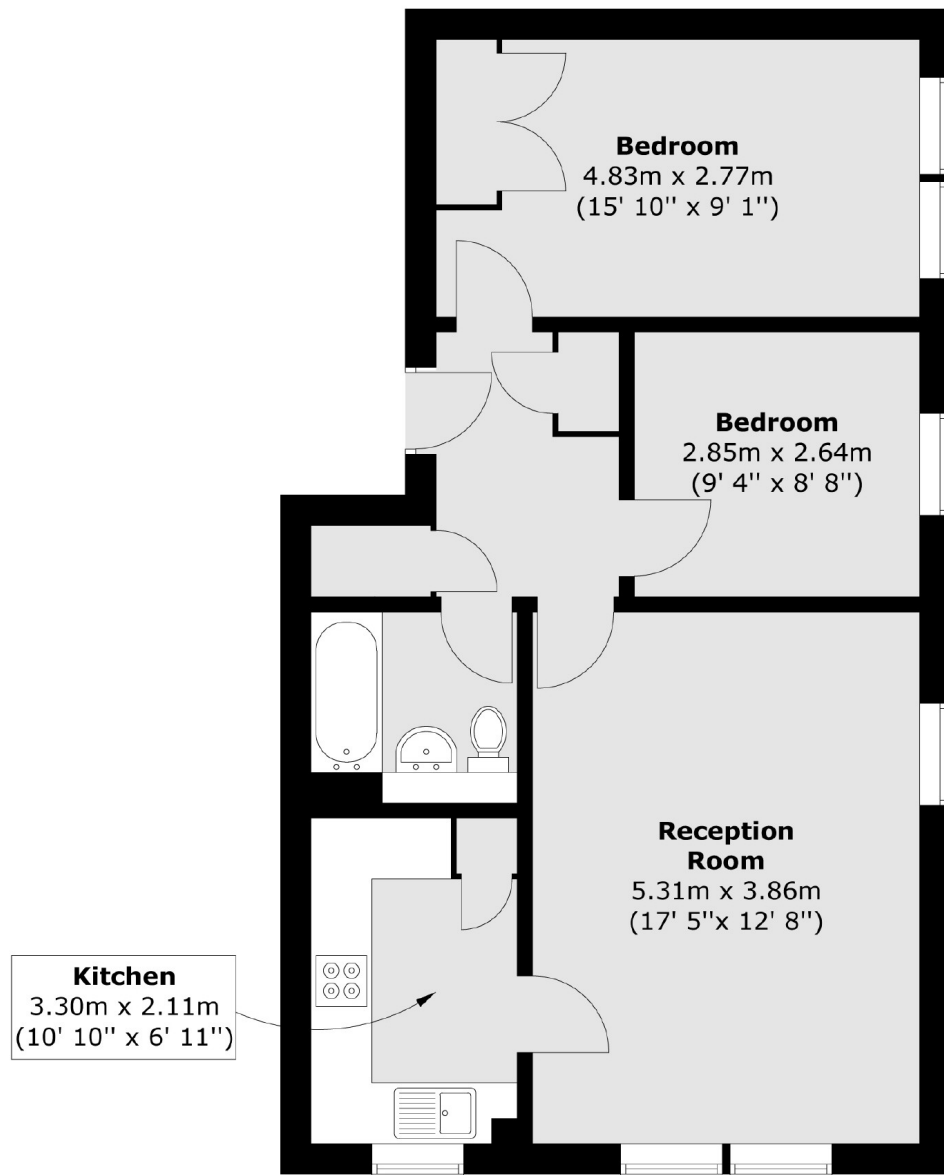

Total area (approx.) : 61 sq. m (657 sq. ft)