



Boundary Lane, SE17

£450,000

A stunning second floor two double bedroom modern development apartment in immaculate condition throughout with a fantastic private balcony being sold with no onward chain.

Roffo Court is located within the sought after Elephant & Castle re-generation zone and within walking distance of Burgess Park. Good local amenities, bus routes as well as the underground stations at Elephant & Castle and Kennington make this a fantastic location.

Features

- Chain Free
- Bike Storage
- Private Balcony
- Communal Courtyard
- Immaculate Condition
- Great Location

Boundary Lane, London, SE17

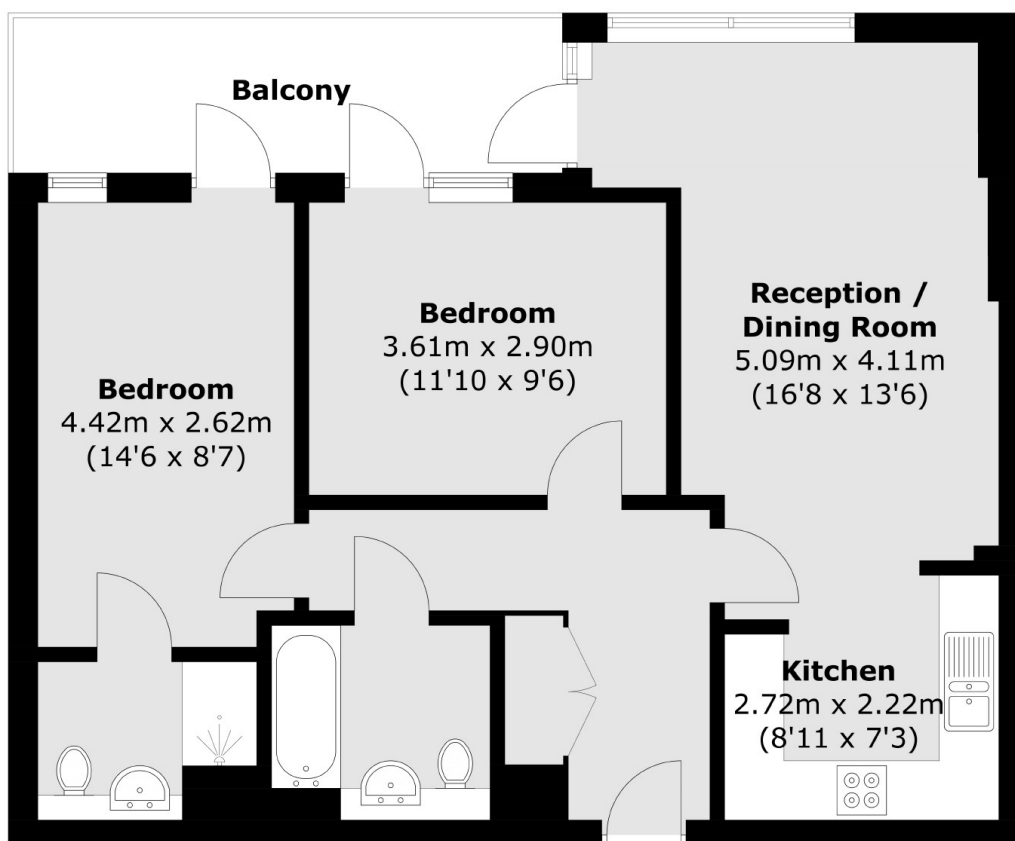

Total area (approx.): 67.9 sq. m (730.9 sq. ft)
Balcony area : 8.7 sq. m (93.6 sq. ft)