



Boundary Lane, SE17

£449,950

A fantastic two double bedroom, two bathroom modern apartment in excellent condition throughout. Positioned on the ground floor the property has a lovely open plan reception room, combining brilliantly with the stylish modern kitchen and benefitting from direct access onto a private terrace. Furthermore there is a good amount of storage and this would make a fantastic first time purchase or investment. Sold with no onward chain.

Roffo Court is quietly located just off the Walworth Road, within easy reach of Elephant & Castle mainline and tube stations (Northern & Bakerloo Lines). There is an excellent array of local shops, restaurants and coffee shops close as are the green spaces of Burgess Park. This is the perfect position for the busy commuter with regular bus links going in all directions.

Features

- Two Double Bedrooms
- Excellent Condition
- Two Bathrooms
- Private Terrace
- Storage
- Secure Bike Storage

Boundary Lane, London, SE17

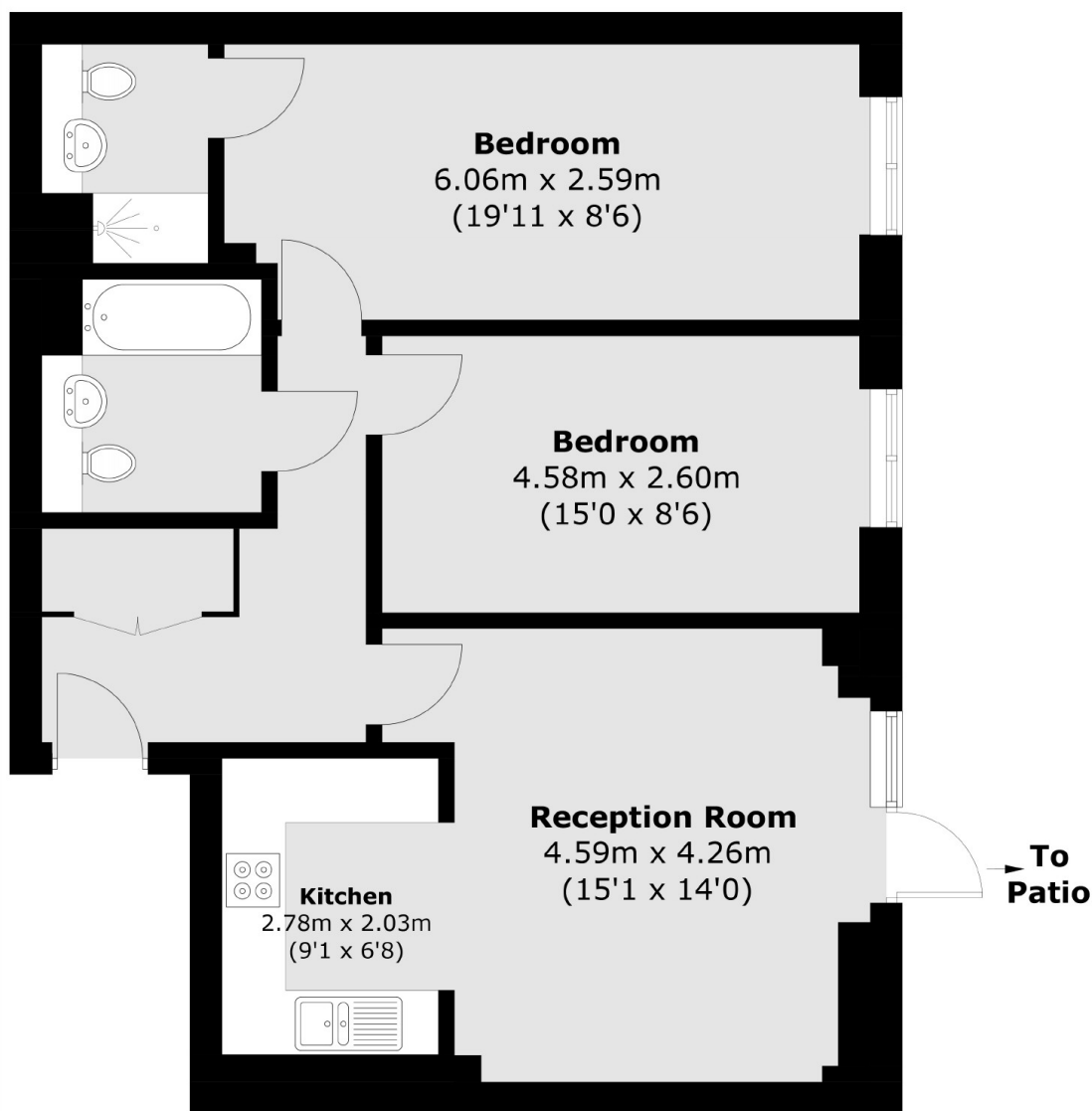

Total area (approx.): 70.1 sq. m (754.5 sq. ft)