

Wesley Close, SE17

£685,000

A spacious mid terrace four bedroom family home that is in great condition and ready to be moved into. The house is conveniently laid out over three floors with four double bedrooms and an impressive garden.

Quietly tucked away within easy reach of Elephant and Castle and Kennington, arguably one of the most exciting areas, with its rapid growth and vast array of local trendy amenities. Access to Northern and Bakerloo Lines provide easy access into the West End & City.

Features

- Freehold Home
- Great Condition
- Patio Garden
- Large Reception Rooms
- Excellent Location
- Four Bedrooms

Wesley Close, London, SE17

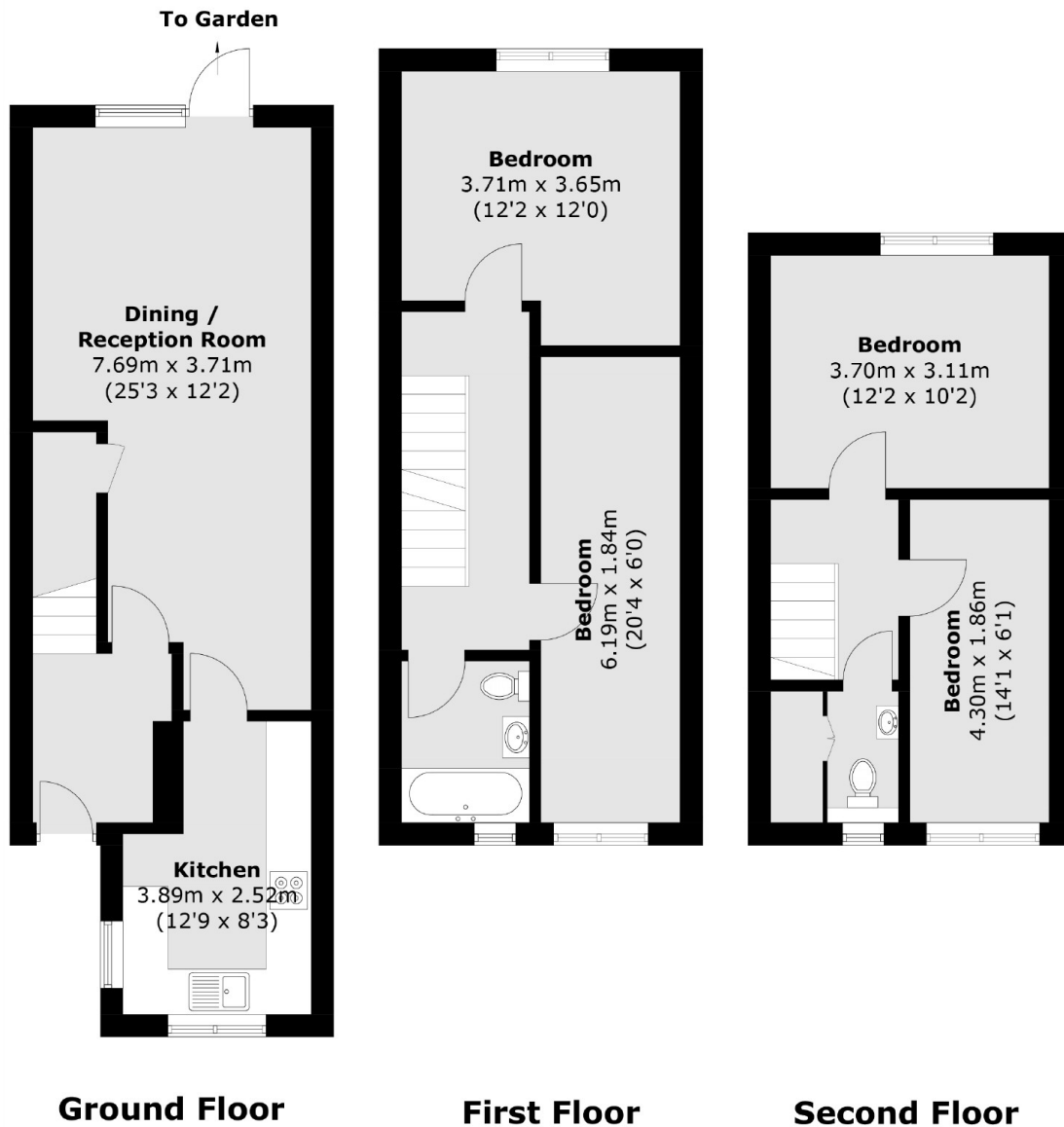

Total area (approx.): 105.7 sq. m (1,137.8 sq. ft)