

The Dial House

Walgrave, Northampton



RICHARD  GREENER



The Dial House

Walgrave, Northamptonshire.

A traditional country home nestled away in the
Northamptonshire Landscape

Accommodation

Ground Floor: Reception room | Drawing room | Dining Room |
Kitchen/Breakfast room | Cloakroom | Utility/Laundry | Bootroom
| Games room | Office | Studio | Party room

First Floor: Half landing | Master bedroom with ensuite |
Main landing | Bedroom two | Bedroom three | Bedroom four |
Jack & Jill shower room | Bedroom five | Family bathroom

Second Floor: Landing | Bedroom six | Shower room

Outside: Outbuildings | Threshing Barn | Stables | Lodger |
Parking

In all 1.4 Acres

RICHARD  GREENER

9 Westleigh Office Park, Moulton Park,
Northampton, NN3 6BW
www.richardgreener.co.uk



Description

This charming detached Georgian period stone Country house is prominently situated in the heart of Walgrave village, Northamptonshire. Meticulously refurbished by the current proprietors, the property boasts six bedrooms spread across three floors, complemented by two reception rooms, a games room, a home office, a studio, and a spacious party room, encompassing approximately 4,400 square feet of living space.

Rich in character features, the residence offers a welcoming ambience with generously proportioned open receptions and family areas. The expansive gardens, meticulously maintained, provide a serene backdrop, offering picturesque views from various vantage points around the house. Additionally, discreetly situated at the rear is a wooded paddock, along with a detached stone barn suitable for storage, stabling, and accommodations, accompanied by gated off-road parking capable of accommodating multiple vehicles.

Enhancing the outdoor experience is a splendid party barn, ideal for alfresco dining and entertainment, particularly during the warmer months.











Gardens and Outbuildings

Approach through double leaf electrically operated courtyard gates, there is a private gravelled drive leading to a parking/turning area within the walled courtyard adjacent to which there is an aluminium framed greenhouse adjacent to the outbuildings.

On the western side of the house there is an extensive lawned area which is largely walled and bounded by Will Stock flower borders with some fine specimen shrubs and a rare White Mulberry tree together with mature Cherry which stands adjacent to a sun terrace accessed from the Drawing Room. Beyond the walled garden there is a small orchard of established fruit trees including cooking and eating Apple, Pear and Plum trees. The grass paddock stretches way beyond the orchard to the rear of the stone barn and contains some fine specimen trees including Homo, Sweet Chestnut, Lime, Oak, Ash, Cherry and Horse Chestnut and at the far end of the paddock there is an expanse of wild flower gardens.



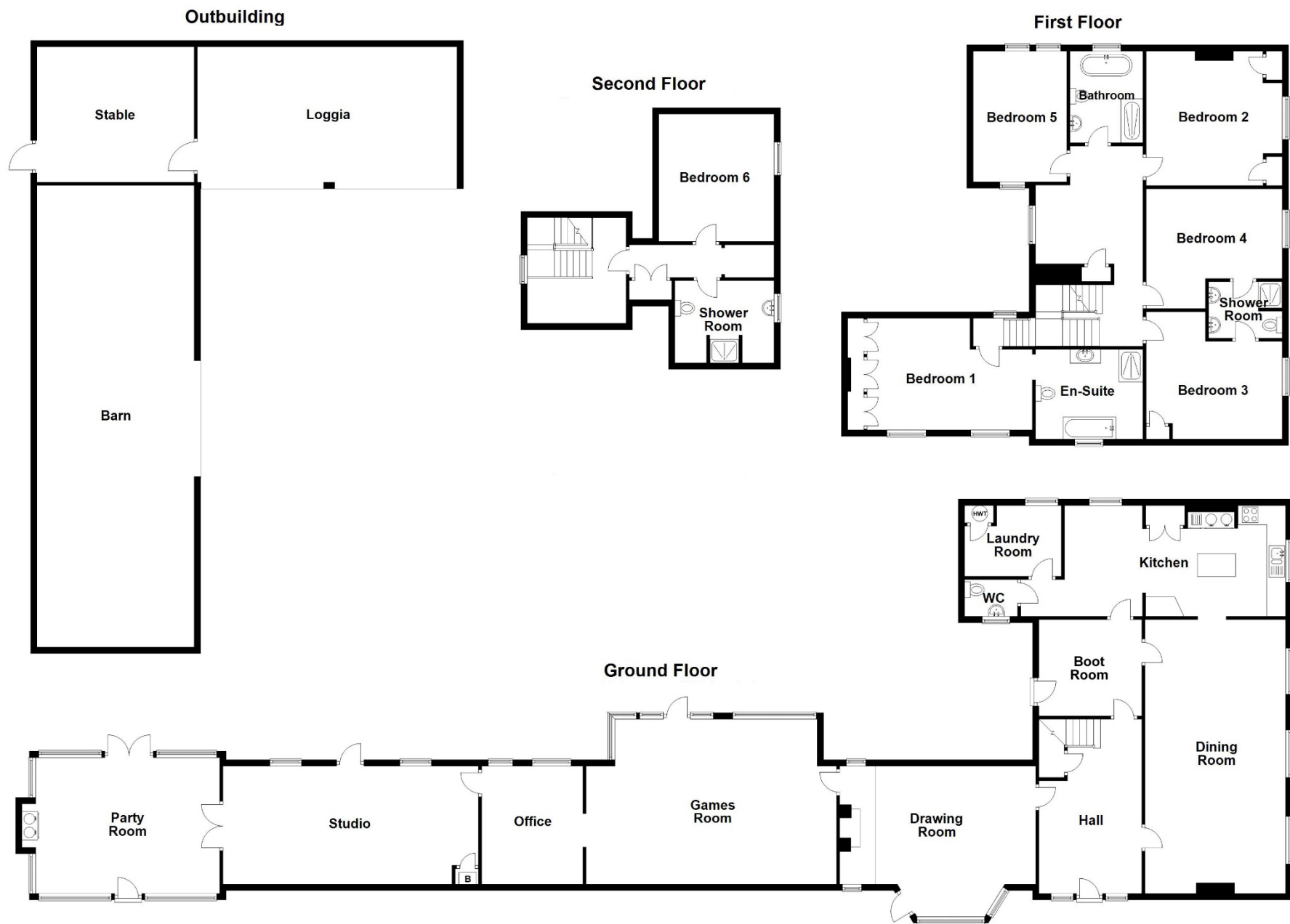

For illustration purposes only - not to scale



Location

Walgrave Village in Northamptonshire exudes quintessential English charm with its picturesque countryside setting and traditional architecture. Despite its tranquil ambience, the village boasts decent connectivity through local transport links. While not directly served by rail, Walgrave Village benefits from proximity to nearby towns like Northampton and Kettering, both of which have railway stations providing connections to major cities like London, Birmingham, and beyond. Regular bus services also connect the village to neighbouring towns and villages, facilitating easy access to essential amenities and broader transportation networks. Within the village itself, residents often rely on cars for daily commuting and errands, given its rural location. However, cycling and walking are popular modes of transportation, thanks to the area's scenic trails and relatively flat terrain. Overall, Walgrave Village offers a tranquil retreat from the urban bustle without sacrificing access to essential transport links for residents and visitors alike.





RICHARD  GREENER