

## Flat 4 10 High Street, Gayton, Northampton, Northamptonshire, NN7 3HD

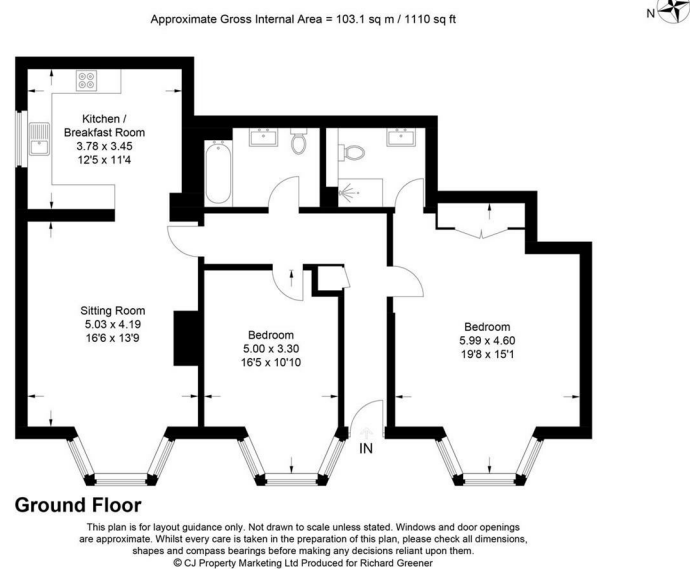

### £250,000 Leasehold

A very well presented, two double bedroom, ground floor apartment offered in immaculate condition by the current owners. The Victorian building was converted to apartments in 2020 by local developers to a very high standard. The accommodation has over 1,100 square feet and comprises of a reception hall, sitting room with bay window, kitchen/dining room with built in appliances, 19 ft main bedroom with an en-suite shower room, 16 ft second bedroom and main bathroom. Outside is a communal seating area for residents and there are two allocated parking spaces. The property is located in the popular village of Gayton which lies to the West of Northampton and offers access to the M1 Junction 15a and A43.



You may download, store and use the material for your own personal use and research. You may not republish, retransmit, redistribute or otherwise make the material available to any party or make the same available on any website, online service or bulletin board of your own or of any other party or make the same available in hard copy or in any other media without the website owner's express prior written consent. The website owner's copyright must remain on all reproductions of material taken from this website.

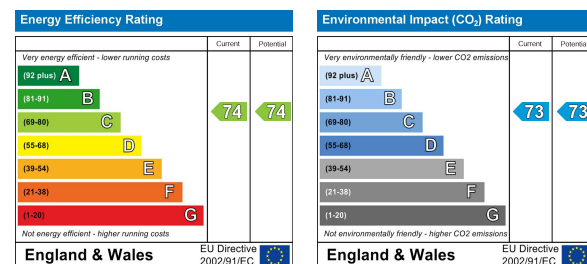

# Flat 4 10 High Street, Gayton, Northampton, Northamptonshire, NN7 3HD

## ACCOMMODATION

### ENTRANCE HALL

Enter via double glazed front door to:

### RECEPTION HALL

Wood laminated floor. Oak doors to a built-in cloaks cupboard and further oak doors to sitting room, both bedrooms and main bathroom:

### SITTING ROOM

19'9 x 13'5

Double glazed walk-in bay window to front aspect. Radiator. Television point. Walk through to kitchen/dining room.



### BEDROOM ONE

19'5 x 14'8

(Into bay) Double glazed walk-in bay window to front aspect. Built-in double wardrobe. Television point and oak door to en-suite.



### EN-SUITE

Three-piece white suite comprising; shower cubicle with rain water shower head, pedestal wash hand basin and low level WC. Porcelain tile floor and tile splash back areas.



### BEDROOM TWO

16'5 x 10'8

(Into bay) Walk-in double glazed bay window to front aspect. Radiator and television point.



### BATHROOM

Three piece white suite comprising; panelled bath with mixer tap and shower attachment. Pedestal wash hand basin and low level WC. Built-in linen cupboard. Porcelain tiled floor and tiled splash back areas. Radiator.



### OUTSIDE

Communal seating area for residents to the rear of the parking area.



### PARKING

Two allocated parking spaces.



### KITCHING/DINER

12'4 x 10'7

Range of matching base and eye level units comprising; stainless steel one and a half bowl sink unit with cupboards under. Built-in electric hob with electric double oven under and stainless steel canopy extractor fan above. Roll top work surfaces and tiled splash back areas. Integrated dishwasher and fridge/freezer. Double glazed window to side aspect. Porcelain tiled floor. Cupboard housing gas boiler. Radiator.

For further information on viewing call 01604 230222