



8a Manor Road North, Esher  
£2,000 pcm

# 8a Manor Road North

Esher, Esher

Split-level, three double bedroom maisonette, ideally placed for Hinchley Wood station and local schools.

- Three double bedrooms
- Unfurnished
- Close to local amenities and Hinchley Wood station
- Separate utility area
- Modern kitchen and bathroom
- Available from 22nd April





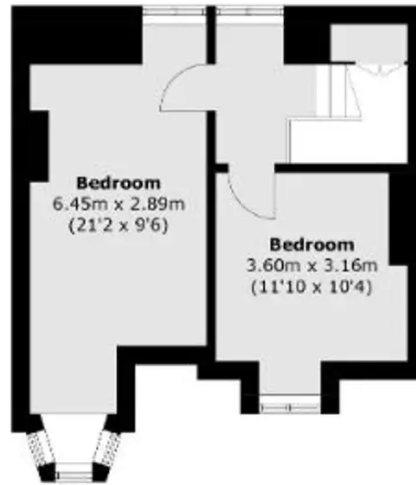

**Second Floor**



**Ground Floor**

**First Floor**

Total area (approx.): 89.4 sq. m (962.2 sq. ft)  
(Including Lean To)