



Beech Croft 73 Crowlees Road , Mirfield, WF14 9PG

FOR SALE WITH NO CHAIN! A charming and historic five bedroom family home. Originally built in 1871 and designed by George Gilbert Scott, this stunning property was once a 10-bedroom vicarage for the Parish Church before being thoughtfully divided into three elegant residences - of which Beech Croft is one. Steeped in history and character, the home showcases an array of original period features while offering spacious, versatile living for today's modern family. Tucked away in a peaceful, private setting, yet just a short walk to the town centre, local shops, and the highly regarded Crowlees Primary School, Beech Croft combines comfort with convenience. Excellent transport links include a railway station within a 15-minute walk—providing connections to Huddersfield, Leeds, Manchester, and direct services to London—as well as easy access to nearby motorway networks. Surrounded by generous, well-maintained gardens, this exceptional home offers ample outdoor space to relax and entertain, alongside a gated driveway and a double garage for secure parking.

£695,000

Beech Croft 73 Crowlees Road

, Mirfield, WF14 9PG



- DATING BACK TO 1871, ORIGINALLY BUILT AS A 10 BEDROOM VICARAGE BEFORE BEING SPLIT INTO THREE HOUSES
- A SHORT WALK TO THE RAILWAY STATION & CLOSE TO MOTORWAY NETWORKS.
- FIVE BEDROOMS WITH A FLEXIBLE LAYOUT BLENDING PERIOD CHARM AND MODERN COMFORT
- GOOD SIZED GARDENS, GATED DRIVEWAY & DOUBLE GARAGE
- NESTLED AWAY, YET A SHORT WALK TO THE CENTRE OF TOWN, AMENITIES & SCHOOLS
- NO VENDOR CHAIN

Entrance	Ensuite
Sitting Room	Bedroom Two
Dining Room	Bedroom Three
WC	Bedroom Four
Study	Bedroom Five
Open Plan Living Kitchen	Garden, Driveway & Double Garage
Utility	
WC	
Cellar	
First Floor Landing	
Bathroom	
Master Bedroom	



Directions

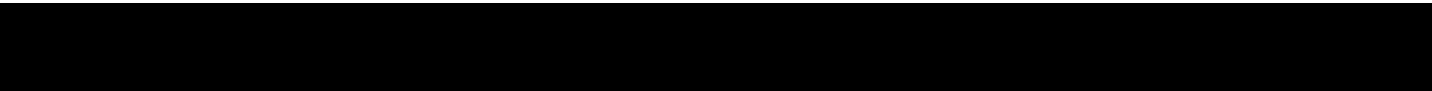



Floor Plan

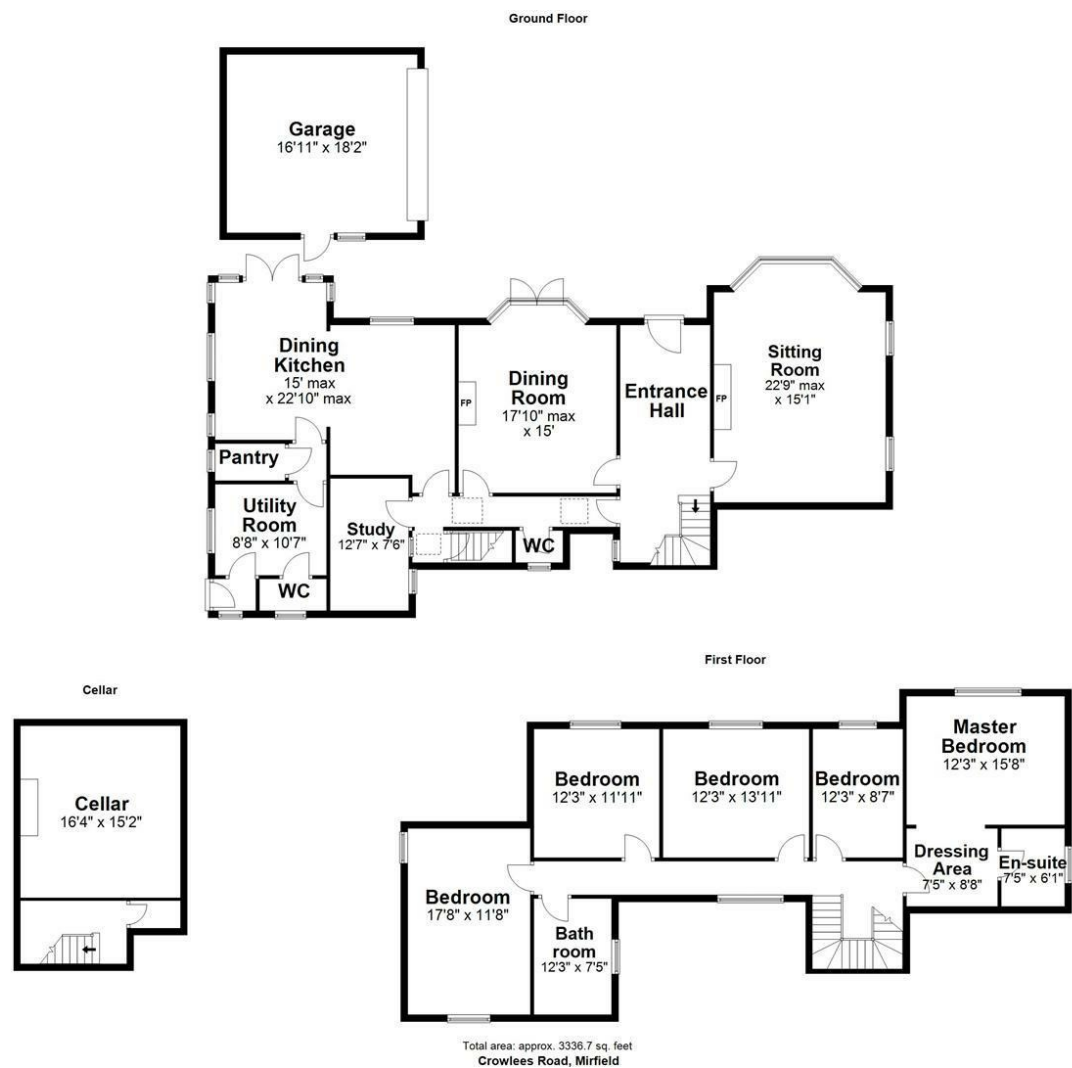

These particulars, whilst believed to be accurate are set out as a general outline only for guidance and do not constitute any part of an offer or contract. Intending purchasers should not rely on them as statements of representation of fact, but must satisfy themselves by inspection or otherwise as to their accuracy. No person in this firms employment has the authority to make or give any representation or warranty in respect of the property.

