



**Snow
Gate™**

**Estate
agency
done
properly**



Flat 29 Autumn Heights

Kitson Hill Road, Mirfield, WF14 9BY

A one double bedroom second floor flat located within this popular development. Capturing the breathtaking rural views from the Juliet balcony for as far as the eye can see! A short distance to the centre of Mirfield which offers a wide variety of amenities and excellent public transport links. The railway station connects neighbouring towns and cities such as; Huddersfield, Leeds and Manchester, as well as having a direct line to London. Motorway networks are also within close proximity. Enjoying well maintained communal gardens as well as parking which is available for residents and visitors. Also having communal lounges for residents to socialise. NO CHAIN!

£119,950

Flat 29 Autumn Heights

Kitson Hill Road, Mirfield, WF14 9BY



- ONE DOUBLE BEDROOM FLAT
- LOCATED ON THE SECOND FLOOR WITH LIFT ACCESS
- OVER 55'S ONLY
- LOCATED A SHORT DISTANCE TO THE CENTRE OF TOWN & AMENITIES
- STUNNING VIEWS TO THE REAR ASPECT
- NO CHAIN

Entrance

Open Plan Living Kitchen
27'6" x 15'1" (max) (8.4 x 4.6 (max))

Bathroom
9'6" x 7'10" (2.9 x 2.4)

Bedroom
14'1" x 9'2" (max) (4.3 x 2.8 (max))

Parking

Communal





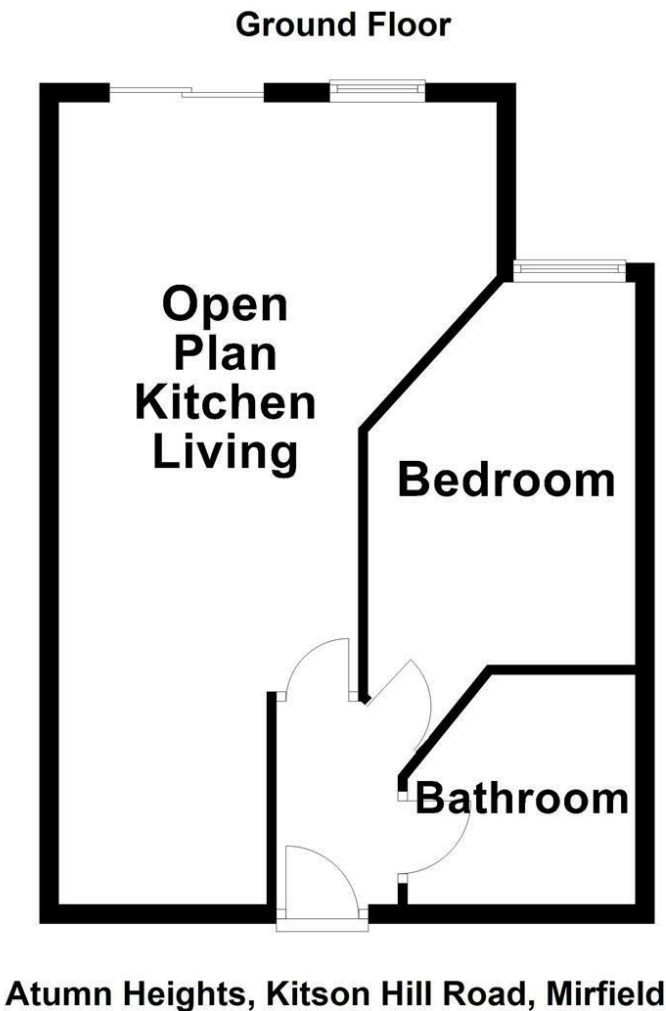

These particulars, whilst believed to be accurate are set out as a general outline only for guidance and do not constitute any part of an offer or contract. Intending purchasers should not rely on them as statements of representation of fact, but must satisfy themselves by inspection or otherwise as to their accuracy. No person in this firms employment has the authority to make or give any representation or warranty in respect of the property.

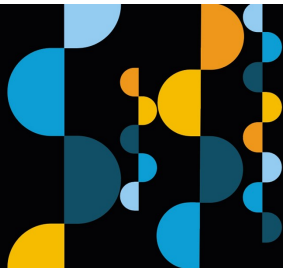
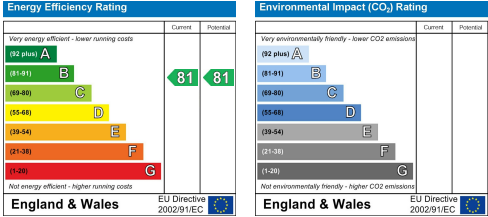

**Estate
agency
done
properly**

**Snow
Gate™**

Holmfirth 26 Victoria Street, West Yorkshire HD9 7DE
All Enquiries: 01484 680800
Mirfield 108 Huddersfield Road, West Yorkshire WF14 8AF
All Enquiries: 01924 497801
snowgate.co.uk