



## 61 The Maltings

Mirfield, , WF14 9PU

A two-bedroom semidetached property briefly comprising of a lounge, a kitchen, two bedrooms, modern bathroom, garden, parking with beautiful views towards the front of the property. No upper chain. Close to local amenities and motorway links.

Offers In The Region Of £150,000

# 61 The Maltings

Mirfield, , WF14 9PU



- A TWO-BEDROOM SEMIDETACHED
- GARDEN
- NO UPPER CHAIN
- PARKING
- VIEWS TOWARDS THE FRONT OF THE PROPERTY
- CLOSE TO LOCAL AMENITIES

Hallway

Lounge

Kitchen

First Floor Landing

Bedroom One

Bedroom Two

Bathroom

Externally



## Directions

From our office proceed in the direction of Huddersfield. The maltings is a turning off on the right hand side. at the junction turn left and the property is on the right hand side.





## Ground Floor

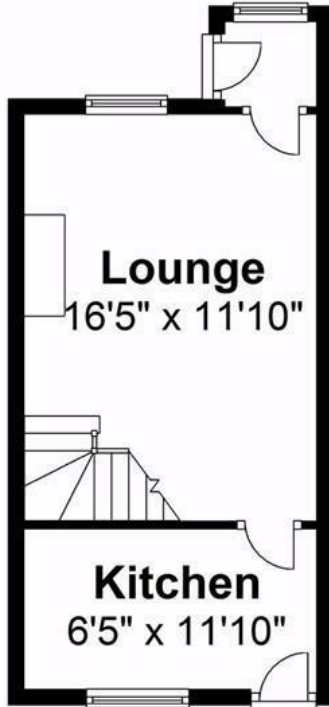

## First Floor

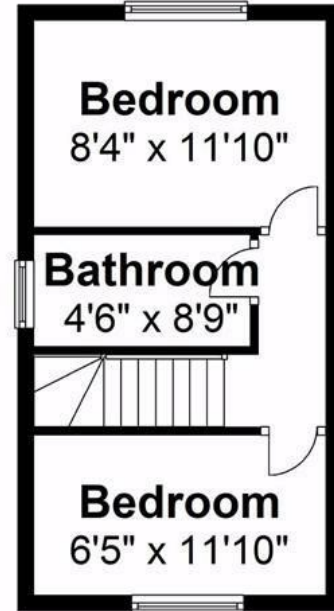

Sketch Plan For Illustrative Purposes Only All measurements of walls, doors, windows, fittings, and appliances their sizes and location are shown conventionally and are approximate only, and cannot be regarded as being a representation either by the Seller, his Agent or DY Energy Assessors Plan produced using The Mobile Agent.

These particulars, whilst believed to be accurate are set out as a general outline only for guidance and do not constitute any part of an offer or contract. Intending purchasers should not rely on them as statements of representation of fact, but must satisfy themselves by inspection or otherwise as to their accuracy. No person in this firm's employment has the authority to make or give any representation or warranty in respect of the property.

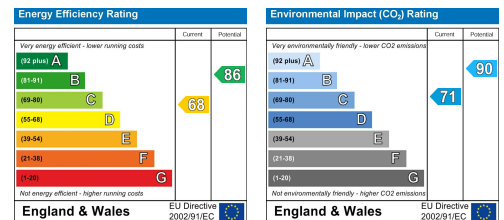

**Estate agency done properly**

**Snow Gate™**

**Holmfirth** 26 Victoria Street, West Yorkshire HD9 7DE  
All Enquiries: 01484 680800

**Mirfield** 108 Huddersfield Road, West Yorkshire WF14 8AF  
All Enquiries: 01924 497801

snowgate.co.uk