



63 Marmaville Court

Mirfield, WF14 9TS

An immaculate two bedroom apartment located on this popular development and conveniently positioned within close proximity to the centre of Mirfield and local amenities. The railway station in the centre of town connects neighbouring towns and cities including; Huddersfield, Leeds and Manchester as well as having a direct line to London. Motorway networks are also nearby. This spacious apartment, which is positioned on the third floor and having lift access, briefly comprises; entrance hallway, living/dining room, kitchen, master bedroom with ensuite, bedroom two, bathroom. Also having an allocated parking spaces with additional visitor spaces available. Well kept communal gardens surround the development for residents to enjoy. NO CHAIN!

£179,995

63 Marmaville Court

Mirfield, WF14 9TS



- WELL PRESENTED TWO BEDROOM FLAT
- POPULAR DEVELOPMENT
- POSITIONED ON THE THIRD FLOOR WITH LIFT ACCESS
- CONVENIENTLY LOCATED WITHIN WALKING DISTANCE TO THE LOCAL AMENITIES & TOWN CENTRE
- ALLOCATED PARKING & COMMUNAL GARDENS
- NO CHAIN

Entrance

Living/Dining Room

Kitchen

Bathroom

Master Bedroom

Ensuite

Bedroom Two

Gardens & Parking

Lease Details



Directions

The entrance to Marmaville Court is located at the bottom of Church Lane, Mirfield.



Floor Plan

Ground Floor

Approx. 739.4 sq. feet

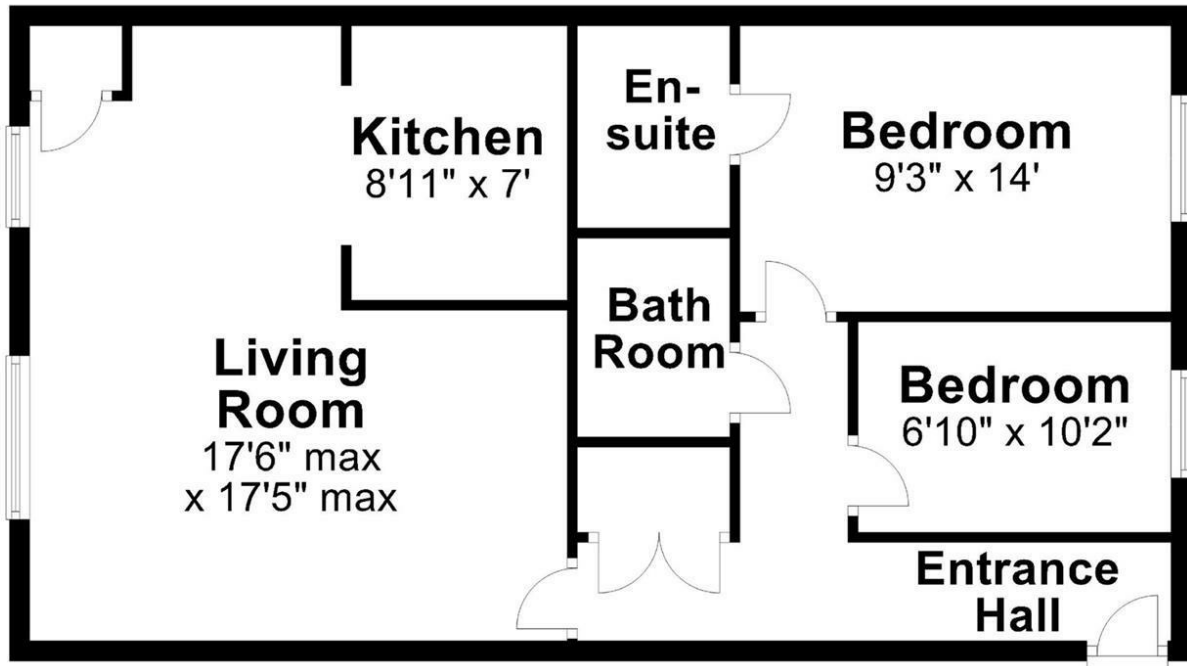

Total area: approx. 739.4 sq. feet

Sketch Plan For Illustrative Purposes Only. All measurements of walls, doors, windows, fittings, and appliances including their sizes and location are shown conventionally and are approximate only. This cannot be regarded as being a representation either by the Seller, his Agent or DY Energy Assessors Plan produced using PlanUp.

63 Marmaville Court, Mirfield

These particulars, whilst believed to be accurate are set out as a general outline only for guidance and do not constitute any part of an offer or contract. Intending purchasers should not rely on them as statements of representation of fact, but must satisfy themselves by inspection or otherwise as to their accuracy. No person in this firm's employment has the authority to make or give any representation or warranty in respect of the property.

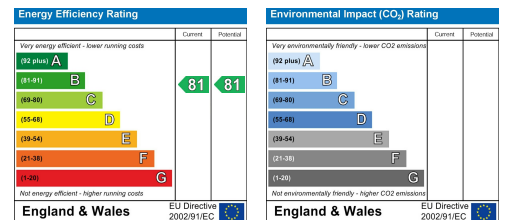

**Estate
agency
done
properly**

**Snow
Gate™**

Holmfirth 26 Victoria Street, West Yorkshire HD9 7DE
All Enquiries: 01484 680800

Mirfield 108 Huddersfield Road, West Yorkshire WF14 8AF
All Enquiries: 01924 497801

snowgate.co.uk