



## Goldsworth Park

**£140,000 Leasehold**

For sale with NO ONWARD CHAIN, this well presented studio apartment in a block with residents parking spaces. Situated in Goldsworth Park overlooking the lake in a pleasant cul-de-sac, this apartment has a bed/sitting room, well presented refitted kitchen and a bathroom. Ideal for a first-time purchase or an investment. Outside, is residents parking.



Goldsworth Park amenities include some excellent primary schools, Waitrose supermarket, selection of local shops, Doctors and Dentist, petrol station and Goldsworth Park Lake itself. A bus service operates through the park connecting Knaphill to Woking, from where there is a fast mainline service to London Waterloo (approximately 26 minutes).

Council Tax Band -B  
Lease - 952years remaining  
Ground rent - £50 pa  
service charge £33.00 p.c.m



# brandons

Veryan, Goldsworth Park, Woking, GU21 3LL

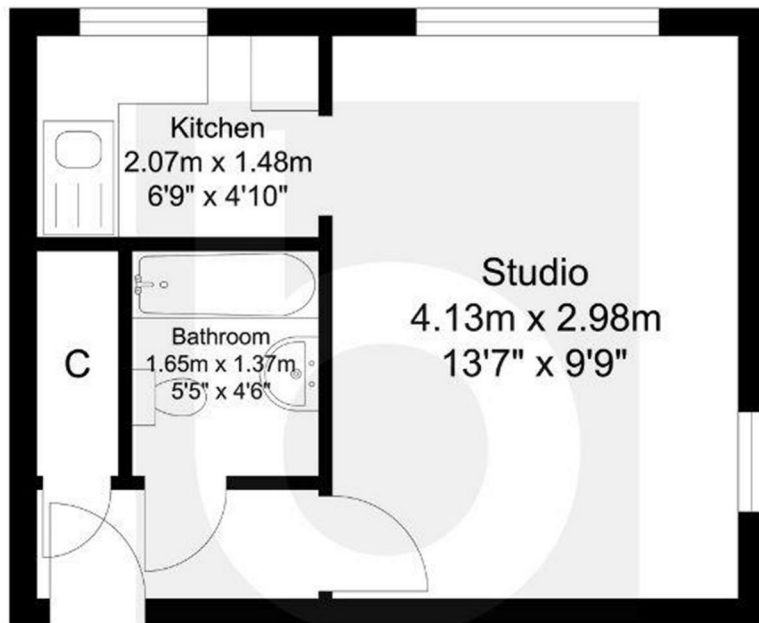

brandons  
Total Approximate Area  
228.94 sq. ft.  
(21.27 sq. m)

brandons residential estate agents have not tested any apparatus, equipment, fixtures or services so cannot verify they are in working order or fit-for-purpose. The buyer is advised to obtain verification from their solicitor or surveyor.

To arrange a viewing please contact brandons residential estate agents on 01483 798840 or email [sales@brandonsmove.co.uk](mailto:sales@brandonsmove.co.uk)

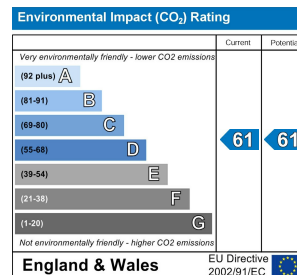
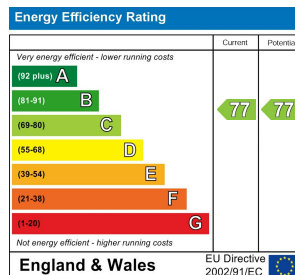

[www.brandonsmove.co.uk](http://www.brandonsmove.co.uk)

these particulars should not form the basis of an offer or contract, although every care has been taken in the preparation, the accuracy is not guaranteed.

