

# SPENCE WILLARD



Land at Bunts Hill Farm, Whitehouse Cross, Porchfield, Isle of Wight, PO30 4LQ

# *Two fields extending to about 12.5 acres of pasture.*

VIEWING

COWES@SPENCEWILLARD.CO.UK 01983 200880 WWW.SPENCEWILLARD.CO.UK

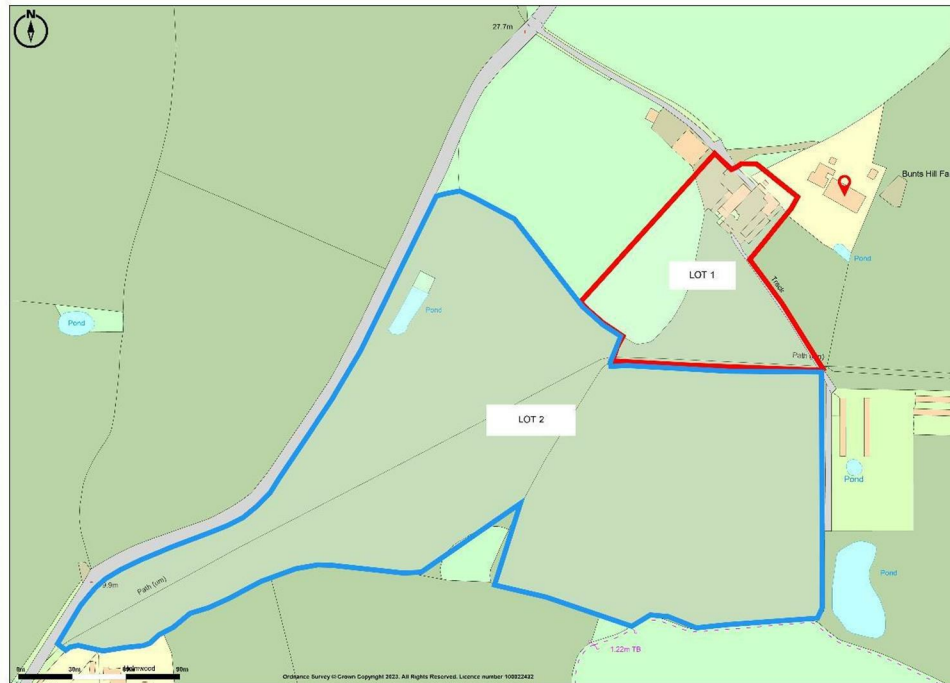

## **Lot 2**

Two fields extending to about 12.5 acres of pasture as shown on the plan attached, one of 7.5 acres and one of 5 acres with direct highway access. There is a small pond within the land and a public footpath that crosses the land. At present, there is no water supply. A proposed restrictive covenant will prevent the erection of any buildings or structures (temporary or permanent) other than those associated with animal housing which would be restricted to a height of 3.5m.

**Promap**  
LANDMARK INFORMATION

Ordnance Survey © Crown Copyright 2023. All Rights Reserved.  
Licence number 100022412  
Printed Scale: 1:2500, Page Size: A4





[SPENCEWILLARD.CO.UK](http://SPENCEWILLARD.CO.UK)

IMPORTANT NOTICE: 1. Particulars: These particulars are not an offer or contract, nor part of one. You should not rely on statements by Spence Willard in the particulars or by word of mouth or in writing ('information') as being factually accurate about the property, its condition or its value. Neither Spence Willard nor any joint agent has any authority to make any representations about the property, and accordingly any information given is entirely without responsibility on the part of the agents, seller(s) or lessor(s). 2. Photos etc: The photographs show only certain parts of the