



Peter
Buswell
Independent Family Estate Agents

Far Reaching Countryside Views In Ewhurst Green

£950,000

🛏️ 4 🚿 2 🚗 1



Nestled within the picturesque countryside, this stunning double roundel oast offers a unique living experience. Boasting 4/5 generously proportioned bedrooms, and a separate dining room, this residence provides ample space for comfortable family living. A loft above bedroom four and storage cupboards throughout provide an abundance of space for storage. The well-appointed kitchen and inviting living room provide cosy retreats, while a garage and carport offer convenient parking options.

The charm of this property extends outdoors, where a west-facing garden awaits, complete with various seating areas perfect for entertaining or simply enjoying the tranquil surroundings. A courtyard off of the kitchen adds an additional relaxing outlook with a beautiful water feature in the center. With views stretching as far as Bodiam Castle, residents can revel in the beauty of the landscape from the comfort of their own home.

If You Lived Here:

Imagine waking up each morning in the idyllic rural village of Ewhurst Green, surrounded by rolling hills and lush greenery. Just a stone's throw away lies Bodiam village, famous for its historic steam train and charming local pub. For outdoor enthusiasts, the area offers an abundance of scenic walks, allowing residents to explore the beauty of the countryside at their leisure.

Whether taking a leisurely stroll or enjoying a pint at the local pub, life in this quaint village offers a peaceful retreat from the hustle and bustle of city living. With Bodiam Castle gracing the horizon, residents are reminded of the rich history and heritage that surrounds them, adding to the timeless appeal of this enchanting location.



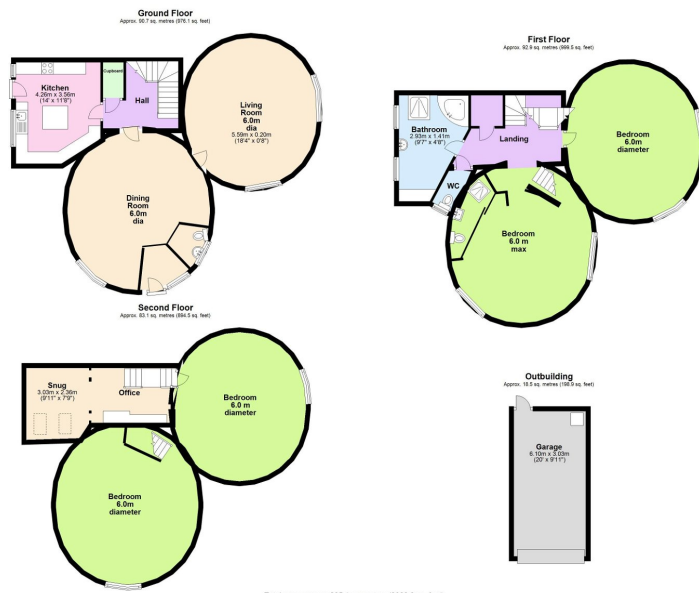

Total area: approx. 285.1 sq. metres (3069.0 sq. feet)

- DOUBLE ROUND EL ATTACHED OAST HOUSE
- STUNNING WEST FACING GARDEN
- VIEWS AS FAR AS BODIAM CASTLE
- RURAL LOCATION
- COUNCIL TAX BAND G
- FOUR/FIVE BEDROOMS
- GARAGE AND CAR PORT
- PRETTY COURTYARD AREA
- EPC RATING N/A

