



Peter
Buswell
Independent Family Estate Agents

A Character Cottage In Burwash Village

£275,000

🛏️ 2 🚿 1 🚻 1



Description

A charming Grade II listed two bedroom cottage set within the popular village of Burwash. This character cottage has two double bedrooms on the first floor with views as far as Ticehurst Church. To the rear is a beautiful mature approx. 70ft garden. Viewing is highly recommended.

Location

With a population of just over 2,500, the Parish of Burwash lies 42 miles south east of central London, and 15 miles north of Hastings and Bexhill. Burwash itself is perhaps best known for its association with Rudyard Kipling who lived at Bateman's, a handsome ironmasters house less than half a mile from the village, and now one of the National Trust's most popular visitor attractions in southern England. Etchingam main line station is only 2 miles away with the London to Hastings line. The A21 is just 4 miles away which is the major road link between London, Sevenoaks and Hastings. Burwash is an excellent base for trips to London and the coast, and for visiting the numerous famous gardens, castles, historic houses, towns and villages that abound in this beautiful part of southern England. Burwash is a thriving rural community with many attractions for visitors, good shops, post office, pubs, great places to stay, and a host of well supported clubs and societies. Education opportunities exist within the area in both the private and state sector, at all levels. These include Burwash and Etchingam primary schools, Vine Hall pre prep and prep school at Robertsbridge, Battle Abbey and Claremont Prep and Senior school.



Ground Floor
Approx. 26.4 sq. metres (284.0 sq. feet)

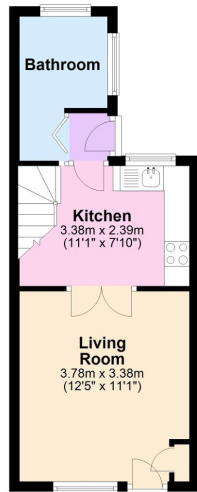

First Floor
Approx. 21.9 sq. metres (235.4 sq. feet)

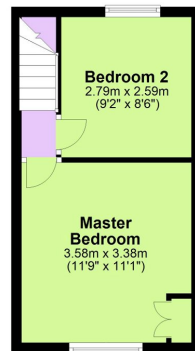

Total area: approx. 48.3 sq. metres (519.4 sq. feet)

- A TWO BEDROOM GRADE II LISTED COTTAGE
- 70FT REAR GARDEN (APPROX)
- LOCATED IN THE HISTORIC VILLAGE OF BURWASH
- EPC RATING N/A
- CHARMING CHARACTER FEATURES INCLUDING A FIREPLACE WITH A WOODBURNING STOVE
- ~~VIEW ACROSS TO~~ TICEHURST CHURCH
- ETCHINGHAM MAIN LINE TRAIN STATION 2.5 MILES
- COUNCIL TAX BAND C