

DIRECT



MOVES



## Osmington

East Farm, Osmington DT3 6EX

- Attractive lounge with spiral staircase
- Countryside walks and coastal paths
  - Village location
  - Modern elements
  - Osmington village
- Charming location.
- Period style thatched cottage
- Walking distance to Jurassic coast and sea
  - Alfresco dining area

**Offers Over £300,000 Freehold**



Local Authority  
Council Tax Band D  
EPC Rating

GROUND FLOOR

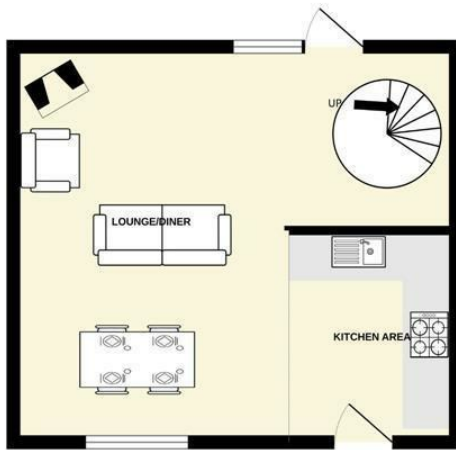

1ST FLOOR

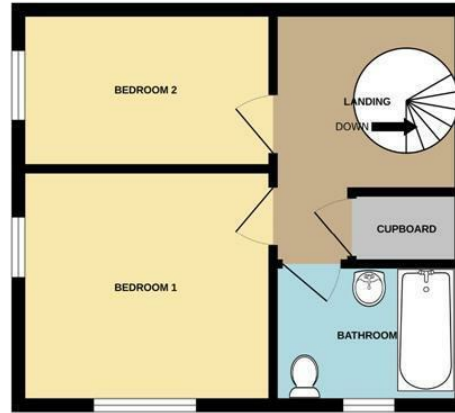

LAUREL COTTAGE

Whilst every attempt has been made to ensure the accuracy of the floorplan contained here, measurements of doors, windows, rooms and any other items are approximate and no responsibility is taken for any error, omission or mis-statement. This plan is for illustrative purposes only and should be used as such by any prospective purchaser. The services, systems and appliances shown have not been tested and no guarantee as to their operability or efficiency can be given.  
Made with Metropix ©2024

**Direct Moves Estate Agents Office**

9 Westham Road  
Dorset  
Weymouth  
DT4 8NP

**Contact**

01305 778500  
sales@directmoves.com  
<https://directmoves.com/>

Agents Note: Whilst every care has been taken to prepare these particulars, they are for guidance purposes only. All measurements are approximate and for general guidance purposes only and whilst every care has been taken to ensure accuracy, they should not be relied upon and potential buyers/tenants are advised to recheck the measurements.

