



Charlesons®

WANSTEAD LANE

ASKING PRICE OF £600,000





\*\*\*OPEN DAY 5TH OCTOBER\*\*\* If you're looking for a house you can put your own stamp and make your own than look no further! This three-bedroom semi-detached house in the ever-popular Wanstead Lane, North Ilford found just off The Drive gives you endless opportunities to create your dream forever home. Inside you have a spacious through lounge diner with separate kitchen. On the first floor you have two generous size double bedrooms and a smaller single bedroom. completing the upstairs accommodation you have the family bathroom. The garden, which leads from both the kitchen and the dining area has considerable size patio are leading to a large lawned area, the perfect balance for BBQ's and the kids to run around. The house has masses of potential (STNPC) both internally and externally. is remarkably close to a variety of amenities, close to Redbridge underground and Ilford overground station, Valentines Park and there is excellent access to the A12/A406 road links. A massive benefit of the property is that it is in Valentines school catchment area. This is one of the most sought-after schools in the Borough and will give your children a head start in your academic life. Viewing is recommended!







**GROUND FLOOR**  
474 sq.ft. (44.1 sq.m.) approx.

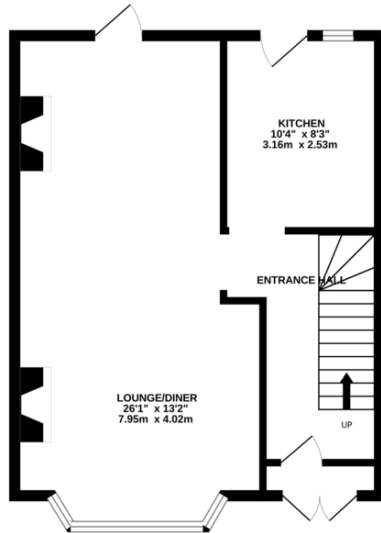

**1ST FLOOR**  
487 sq.ft. (45.3 sq.m.) approx.

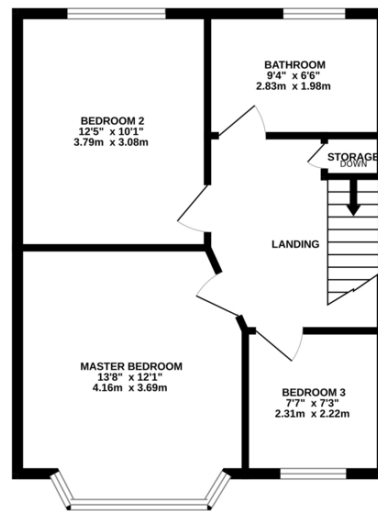

**3 BED SEMI DETACHED**

**TOTAL FLOOR AREA: 962 sq.ft. (89.4 sq.m.) approx.**

Whilst every attempt has been made to ensure the accuracy of the floorplan contained here, measurements of doors, windows, rooms and any other items are approximate and no responsibility is taken for any error, omission or mis-statement. This plan is for illustrative purposes only and should be used as such by any prospective purchaser. The services, systems and appliances shown have not been tested and no guarantee as to their operability or efficiency can be given.  
Made with Metropix ©2024