

**TO LET**



**Co-operative Street, Wath-upon-Dearne**  
**£725 pcm**

  
**MARTIN&CO**

## Co-operative Street, Wath-upon-Dearne

End Terraced House,  
2 bedroom, 1 bathroom

£725 pcm

Date available: 30th September 2025

Deposit: £836

Unfurnished

Council Tax band: A

- Private courtyard garden
- Available now!
- Attic conversion
- Close to local amenities
- Gas central heating
- Neutral decor
- 

Nestled in the heart of Wath-upon-Deame, Co-Operative Street presents a comfortable and thoughtfully laid-out two-bedroom home with a unique bonus attic room, blending practicality and charm. The lounge welcomes with a spacious feel, thanks to a large window that allows natural light to fill the space, making it ideal for relaxing or entertaining. Adjacent to the lounge, the kitchen offers convenience with its oven, extractor fan, and plenty of space for essentials like a fridge and washing machine. A small porchway connects the kitchen to the backyard, which is designed for low maintenance and provides a private



outdoor area for casual enjoyment.

Upstairs, the two bedrooms deliver comfort and versatility. The main bedroom is a generous double with ample room for storage, while the second bedroom is a single, suitable for various needs. The family bathroom is designed with a full white suite, complete with an over-bath mixer shower, tiled flooring, and splash backs that add to the room's clean and practical style.

The property's attic room is an adaptable space, filled with natural light from its two Velux windows. Fully carpeted, this room provides a cozy additional area that could serve as a home office, reading nook, or extra storage, accessible via a loft ladder.

Set within Wath-upon-Dearne, the property is conveniently located near essential local amenities, from supermarkets and eateries to transport links offering straightforward access to surrounding areas like Rotherham and Barnsley. This home provides both the comfort of a well-appointed space and the ease of nearby amenities, making it a practical choice for modern living.

Please register your interest today!

Score	Energy rating	Current	Potential
92+	A		
81-91	B		
69-80	C		80 C
55-68	D	60 D	
39-54	E		
21-38	F		



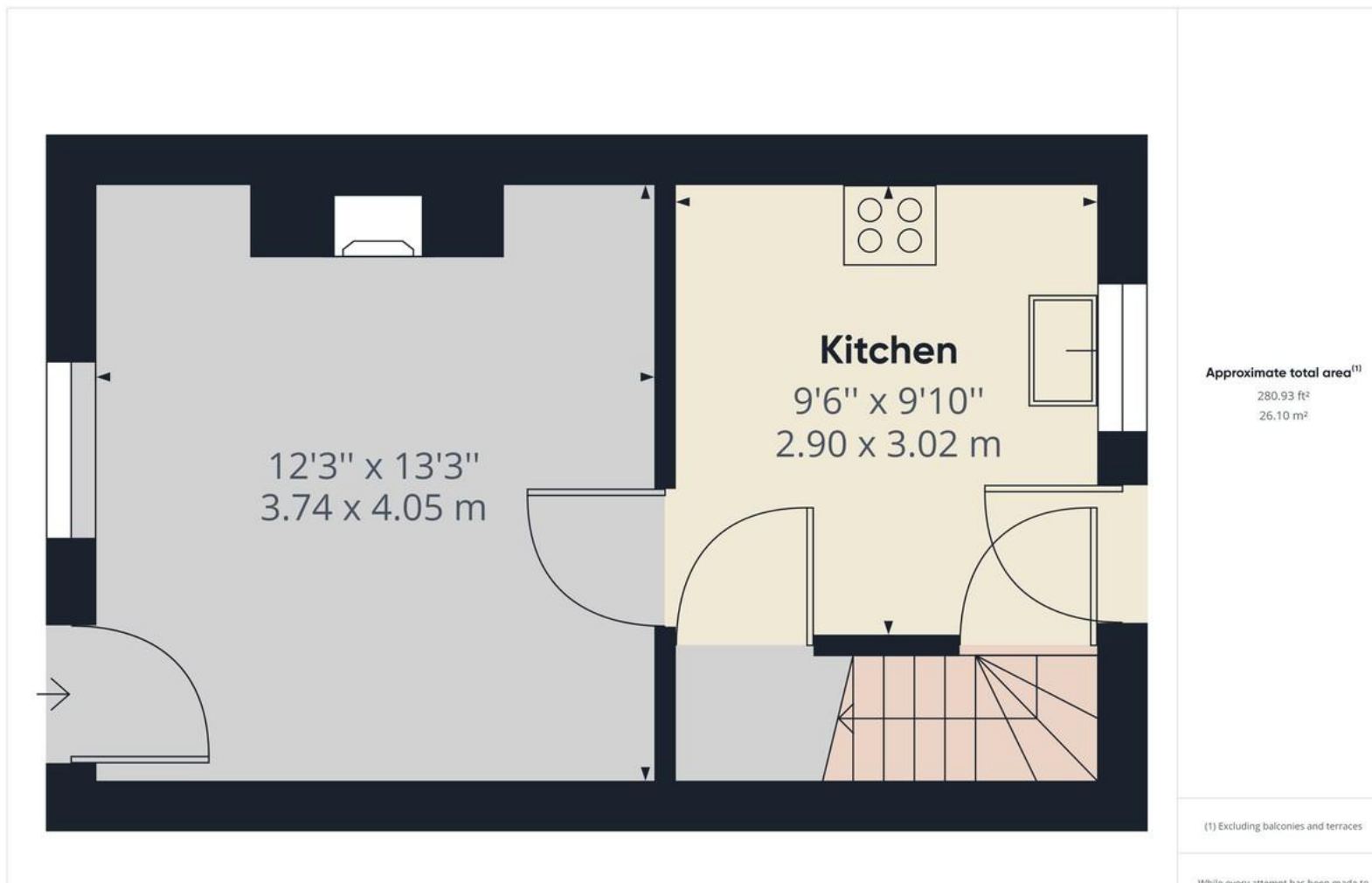

## Martin & Co Rotherham

5 Worry Goose Lane • Whiston • Rotherham • S60 4AA  
T: 01709 544982 • E: rotherham@martinco.com

**01709 544982**

<http://www.martinco.com>



**Accuracy:** References to the Tenure of a Property are based on information supplied by the Seller. The Agent has not had sight of the title documents. A Buyer is advised to obtain verification from their Solicitor. Items shown in photographs including but not limited to carpets, fixtures and fittings are not included unless specifically mentioned within the sales particulars. They may however be available by separate negotiation. Buyers must check the availability of any property and make an appointment to view before embarking on any journey to see a property. No person in the employment of the agent has any authority to make any representation about the property, and accordingly any information given is entirely without responsibility on the part of the agents, sellers(s) or lessors(s). Any property particulars are not an offer or contract, nor form part of one. **Sonic / Laser Tape:** Measurements taken using a sonic / laser tape measure may be subject to a small margin of error. **All Measurements:** All Measurements are Approximate. **Services Not tested:** The Agent has not tested any apparatus, equipment, fixtures and fittings or services and so cannot verify that they are in working order or fit for the purpose. A Buyer is advised to obtain verification from their Solicitor or Surveyor.