

TO LET



Churchfield Terrace, Cudworth
£625 pcm

MARTIN&CO

Churchfield Terrace, Cudworth

Mid Terraced House ,
2 bedroom, 1 bathroom

£625 pcm

Date available: Available Now

Deposit: £721

Unfurnished

Council Tax band: A

- Available now
- Newly decorated
- Sun room
- Enclosed rear yard
- Modern kitchen
-
-

Please welcome to the market this recently re-decorated two bedroomed property in Cudworth. The property is surrounded by fantastic local amenities with a well equipped high street, transport links are also easily accessible.

The property briefly comprises of a spacious living area. The neutral is to the rear, with a sun room leading off the kitchen into the rear yard which is fully enclosed.

Upstairs is the family bathroom, complete with toilet, sink and shower cubicle. The front bedroom is a spacious



double, with neutral walls and grey carpets. The rear bedroom is a single but still a very good size and will accommodate a single bed easily.

This property is available to move into now, please register your interest today!



Score	Energy rating	Current	Potential
92+	A		
81-91	B		86 B
69-80	C		
55-68	D	61 D	
39-54	E		
21-38	F		
1-20	G		





Ground Floor

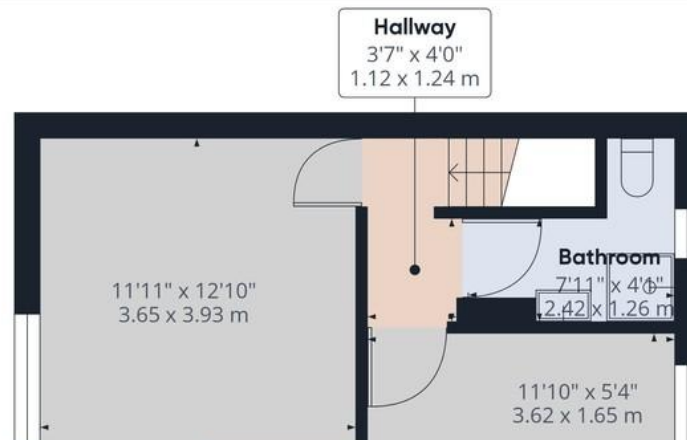

Approximate total area⁽¹⁾
 664.56 ft²
 61.74 m²

(1) Excluding balconies and terraces

While every attempt has been made to ensure accuracy, all measurements are approximate, not to scale. This floor plan is for illustrative purposes only.

Martin & Co Rotherham

5 Worry Goose Lane • Whiston • Rotherham • S60 4AA
 T: 01709 544982 • E: rotherham@martinco.com

01709 544982

<http://www.martinco.com>



Accuracy: References to the Tenure of a Property are based on information supplied by the Seller. The Agent has not had sight of the title documents. A Buyer is advised to obtain verification from their Solicitor. Items shown in photographs including but not limited to carpets, fixtures and fittings are not included unless specifically mentioned within the sales particulars. They may however be available by separate negotiation. Buyers must check the availability of any property and make an appointment to view before embarking on any journey to see a property. No person in the employment of the agent has any authority to make any representation about the property, and accordingly any information given is entirely without responsibility on the part of the agents, sellers(s) or lessors(s). Any property particulars are not an offer or contract, nor form part of one. **Sonic / Laser Tape:** Measurements taken using a sonic / laser tape measure may be subject to a small margin of error. **All Measurements:** All Measurements are Approximate. **Services Not tested:** The Agent has not tested any apparatus, equipment, fixtures and fittings or services and so cannot verify that they are in working order or fit for the purpose. A Buyer is advised to obtain verification from their Solicitor or Surveyor.

