



JOHN ROBERTS & Co  
estate agents



20 Chesswood Court Bury Lane, Rickmansworth, WD3 1DF

Guide Price £385,000



2



1



1



D



# 20 Chesswood Court Bury Lane

Rickmansworth, WD3 1DF

- RICKMANSWORTH TOWN CENTRE
- FIRST FLOOR
- TWO BEDROOMS
- KITCHEN
- COMMUNAL GARDENS
- BEAUTIFULLY PRESENTED
- PARKING
- RECEPTION ROOM
- BATHROOM
- EPC RATING: D

This two bedroom apartment is beautifully presented throughout and is conveniently located for Rickmansworth Town Centre. The property benefits from allocated parking and is offered to the market with no onward chain.

Situated on the top floor of the development, the apartment briefly comprises; kitchen, sitting room, two bedrooms and a family bathroom.

Within the last 12 months the property has been decorated and refurbished by the current owner to include, a new bathroom suite, new kitchen units, new carpets and new electric radiators.



## SITUATION:

This property enjoys access to Rickmansworth town centre, with its selection of schools and shops. For the commuter, Rickmansworth has its own railway station, which provides a Metropolitan Line/Chiltern Railways service into London. For those who drive, there is access to the M25 at Junctions 17 and 18. Schooling for children of all ages is available within the district. Leisure facilities are numerous, including several well-known golf courses, such as nearby Moor Park and The Grove. The 100 acre Aquadrome consisting of three lakes, grassland and woodland provides an ideal location for walking, cycling, fishing and numerous watersports.

## VIEWINGS:

By appointment only please via the Vendors' Agents, John Roberts & Co. 47B, Lower Road, Chorleywood, Herts WD3 5LQ. Tel. 01923 285123.

Opening times: Monday to Friday 9:00am to 6:00pm Saturday 9:00am to 4:00pm.

## TENURE:

Leasehold - 95 Years remaining.  
Service Charge - £1,524.60 PA.  
Ground Rent - £300 PA.

## COUNCIL:

Three Rivers DC







## Floor Plans

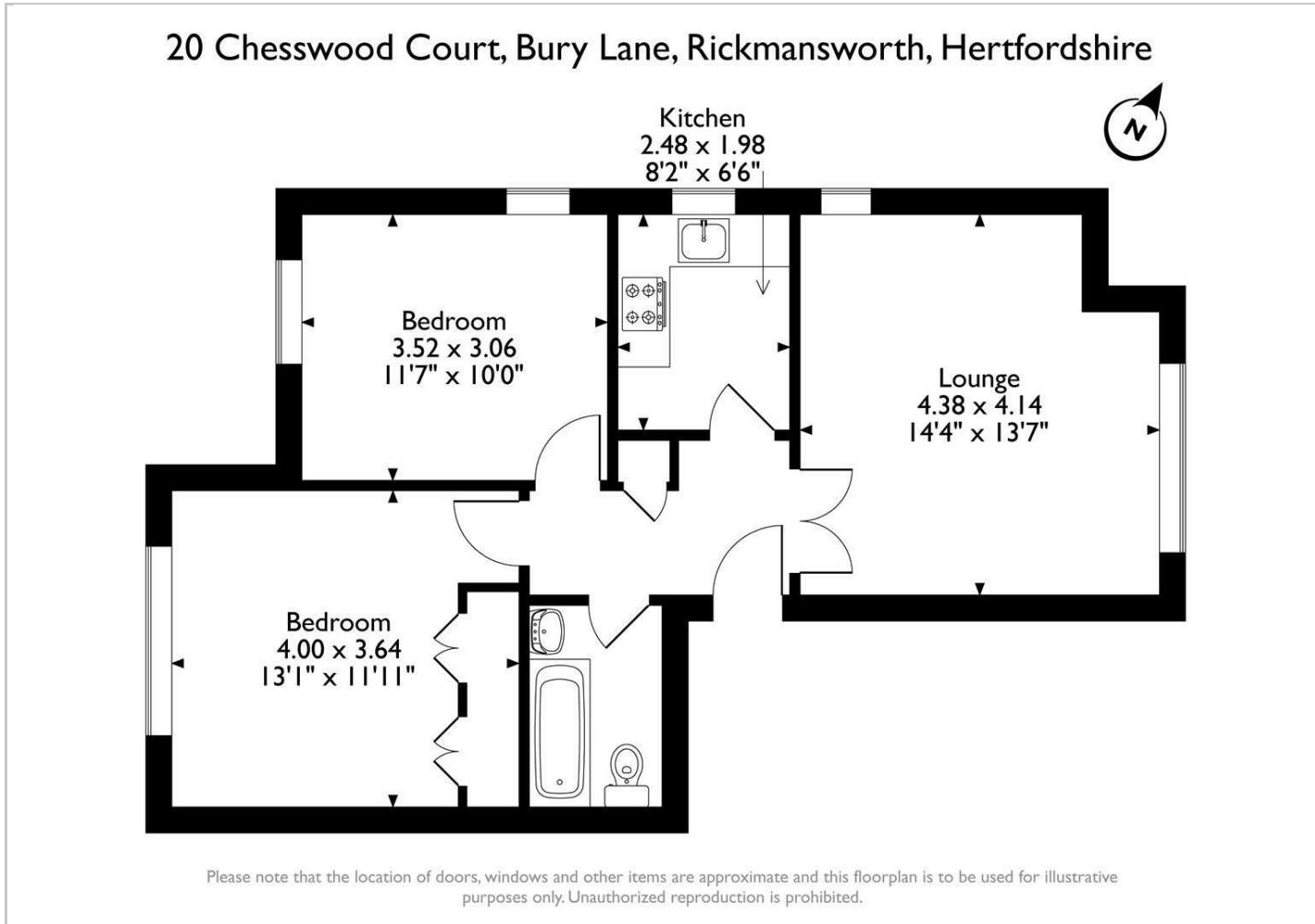

## Viewings

Please contact our John Roberts & Co Office on 01923 285 123 if you wish to arrange a viewing appointment for this property or require further information.

The particulars are set out as a general outline only for the guidance of intended purchasers or lessees, and do not constitute, any part of a contract. Nothing in these particulars shall be deemed to be a statement that the property is in good structural condition or otherwise nor that any of the services, appliances, equipment or facilities are in good working order. Purchasers should satisfy themselves of this prior to purchasing.

47B Lower Road, Chorleywood, Hertfordshire, WD3 5LQ  
Tel: 01923 285 123 Email: james.newman@johnroberts.co.uk <https://www.johnroberts.co.uk>

## Location Map

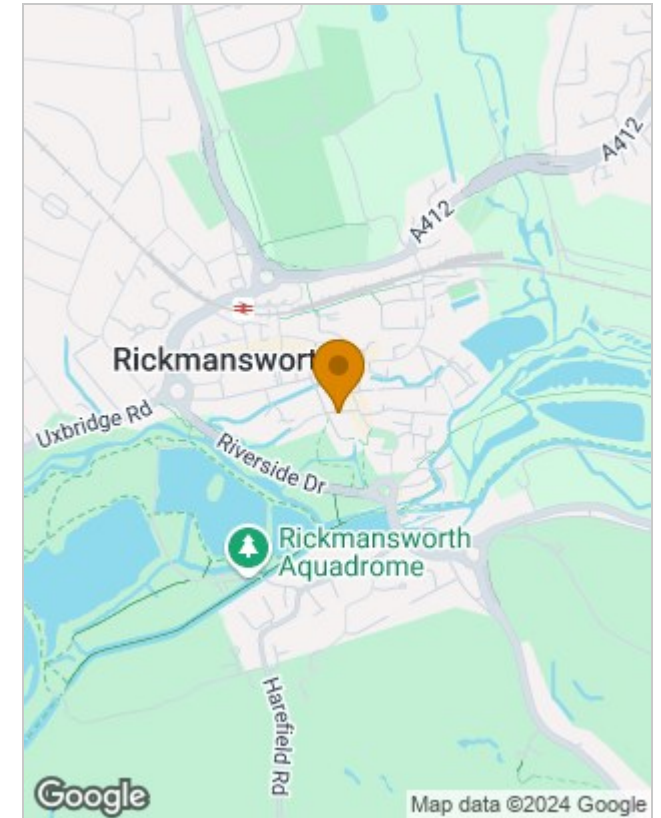

## Energy Performance Graph

