



**Albion Road, Saltergate, Chesterfield, S40 1NB**

 **2**  **1**  **1**  **D**

**£170,000**

**PINEWOOD**



# Albion Road Chesterfield S40 1NB



**£170,000**

**2 bedrooms  
1 bathrooms  
1 receptions**

- 2 cosy double bedrooms with lots of extra space
- 1 modern bathroom, beautifully finished and ready to use
- Spacious reception room with a large uPVC window filling the room with natural light
  - Semi-detached house
- Wonderful kitchen / dining area with ample space for entertaining guests or feeding the family
  - 733 sq ft living space
- Located in Chesterfield, close to Brampton and just beneath Saltergate
  - Ideally located close-by to local amenities
- Easy access to transport and within walking distance of the town center
  - Viewing recommended







DELIC  
CHAR

Nestled on  
semi-de  
1900, th

Spanning  
room  
though  
bathr

The prop  
within ea  
The sun

This s  
charm  
conveni

This love

The large  
overlook  
with draine

The fina  
space fo

This princ  
wardrobe

Bedroom

GROUND FLOOR  
34.6 sq.m. (373 sq.ft.) approx.

1ST FLOOR  
33.5 sq.m. (360 sq.ft.) approx.

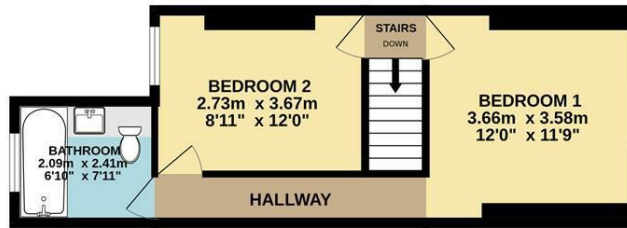
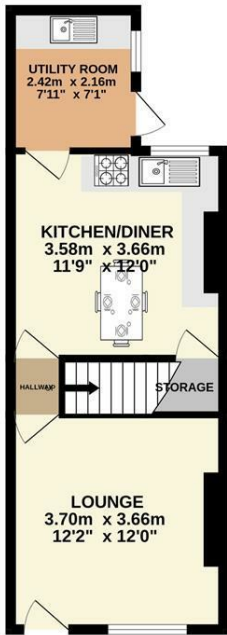

TOTAL FLOOR AREA: 68.1 sq.m. (733 sq.ft.) approx.

Whilst every attempt has been made to ensure the accuracy of the floorplan contained here, measurements of doors, windows, rooms and any other items are approximate and no responsibility is taken for any error, omission or mis-statement. This plan is for illustrative purposes only and should be used as such by any prospective purchaser. The services, systems and appliances shown have not been tested and no guarantee as to their operability or efficiency can be given.  
Made with Metropix ©2025

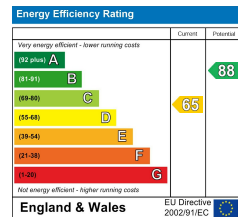

Mansfield branch  
24 Albert Street  
Mansfield, NG1  
01623 621001

Clowne branch  
26 Mill Street,  
Clowne, S43 4JN  
01246 810519

Clay Cross branch  
20 Market Street,  
Clay Cross, S45 9JE  
01246 251194

Chesterfield branch  
33 Holywell Street,  
Chesterfield, S41 7SA  
01246 221039

