



Rydal Crescent, Newbold, Chesterfield, Derbyshire S41 8JB

 2  1  1  EPC C

£800 Per Month

PINEWOOD



**Rydal Crescent
Newbold
Chesterfield
Derbyshire
S41 8JB**



£800 Per Month

**2 bedrooms
1 bathrooms
1 receptions**

■ TWO DOUBLE BEDROOMS

■ LOUNGE WITH BAY WINDOW AND FEATURE FIREPLACE

■ GARDENS TO SIDE AND REAR WITH SHED AND OUTSIDE STORE

■ KITCHEN WITH PANTRY AND STORE

■ DOWNSTAIRS W.C/CLOAKROOM

■ MODERN BATHROOM WITH SHOWER OVER BATH

■ GAS CENTRAL HEATING AND UPVC DOUBLE GLAZING - COUNCIL TAX BAND A

■ SOUGHT AFTER VILLAGE LOCATION

■ ON A BUS ROUTE

■ CLOSE TO ALL THE VILLAGE AMENITIES AND SHORT DRIVE INTO THE TOWN CENTRE AND PEAK DISTRICT



****SOUGHT AFTER VILLAGE LOCATION**GARDENS TO THREE SIDES****

This is a TWO DOUBLE BED semi detached property located in the sought after village of NEWBOLD, on a bus route and close to all the local village amenities, only a short drive into the towns of Sheffield, Dronfield and Chesterfield. The property is entered from the side access into the hallway with large understairs store, downstairs w.c/cloakroom, spacious lounge with feature fire and bay window and a recently fitted kitchen with store and pantry, oven and space/plumbing for a washing machine.

To the first floor is bedroom one being a double with inbuilt wardrobe/store and bedroom two also a double to the rear with far reaching views and inbuilt wardrobe/store. The bathroom has a white three piece suite with shower over bath and there is also an inbuilt store to the landing and cupboard. To the front side and rear are gardens with shed and outside store. uPVC Double Glazing and Gas Central Heating.

****VIRTUAL VIDEO TOUR AVAILABLE - Take a look around****

****If you would like to view this property, or apply for it, please click the 'Request Details' button on Rightmove and enter your information****



GROUND FLOOR
38.1 sq.m. (410 sq.ft.) approx.



1ST FLOOR
37.4 sq.m. (402 sq.ft.) approx.

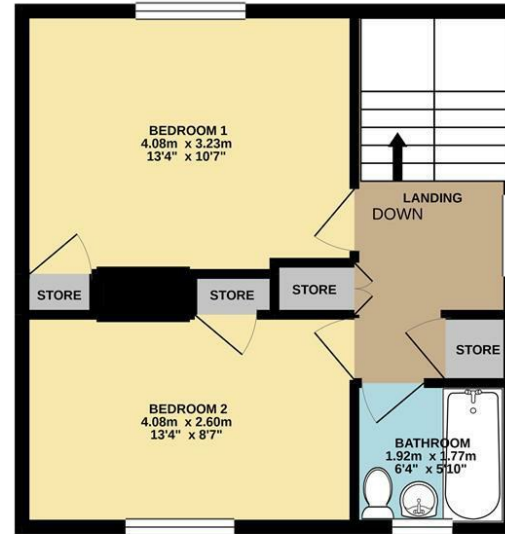

TOTAL FLOOR AREA: 75.4 sq.m. (812 sq.ft.) approx.

Whilst every attempt has been made to ensure the accuracy of the floorplan contained here, measurements of doors, windows, rooms and any other items are approximate and no responsibility is taken for any error, omission or mis-statement. This plan is for illustrative purposes only and should be used as such by any prospective purchaser. The services, systems and appliances shown have not been tested and no guarantee as to their operability or efficiency can be given.
Made with Metropix ©2021.

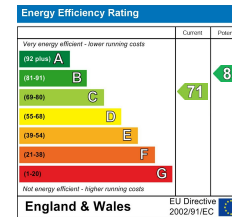

Mansfield branch
24 Albert Street
Mansfield, NG1
01623 621001

Clowne branch
26 Mill Street,
Clowne, S43 4JN
01246 810519

Clay Cross branch
20 Market Street,
Clay Cross, S45 9JE
01246 251194

Chesterfield branch
33 Holywell Street,
Chesterfield, S41 7SA
01246 221039

PINEWOOD

