



5 Barnoon Terrace

St. Ives

Price Guide £995,000

 **Millerson**
Select

5 Barnoon Terrace

St. Ives

- 4 DOUBLE BEDROOMS
- LARGE OPEN PLAN RECEPTION ROOM
- KITCHEN-DINER
- 2 BATHROOMS
- GARDENS
- PARKING
- STUNNING 180-DEGREE VIEWS
- BEING SOLD FULLY FURNISHED
- HOLIDAY LET /PRIVATE HOME
- VIEWING HIGHLY RECOMMENDED

A stunning home set within one of St Ives premier terraces offering 180 degree views from Porthmeor and around to Porthminster point and taking in the whole of St Ives bay. Internally the home offers spacious well presented family living including the living room. Dining room that leads through to the kitchen. There are 4 bedrooms and 2 bathrooms set over the first second floor levels and as you rise up through the house the views get better and better. To the front is a sun terrace along with an enclosed well stocked garden whilst to the rear an enclosed courtyard garden. There is parking for 2 cars. Viewing is a must.







Location

In recent years St Ives has become one of Europe's premier holiday destinations, famed for its beautiful beaches, coastal paths, Mediterranean quality of light and maze of narrow cobbled streets, filled with an eclectic range of shops, restaurants, bars and galleries, including The Tate, and the Barbara Hepworth Museum and Sculpture Garden. The town is renowned for its artist community and was once the home and inspiration for artists and ceramicists such as: Leach, Whistler, Nicholson, Turner, Hepworth and Wallis.

There is a picturesque harbour where you can watch local fishing boats return with their catch. If you are lucky, you may spot seals or dolphins in the bay. There are five glorious, sandy beaches, including the nearby Carbis Bay and the famous surfing beach of Porthmeor which is overlooked by The Tate. The beautiful coastal paths from St Ives are a treat for walkers and bird watchers.

The Property

Seascape is a beautifully presented 4-bedroom, Victorian property on one of the most attractive and sought-after pedestrian terraces in St Ives. Its semi-tropical gardens are a delight at all times of the year; a peaceful oasis just a moment away from the town and beaches. The property offers stunning and ever-changing 180-degree views from The Island to the harbour, out into the bay, across to Godrevy Lighthouse and beyond to Trevoze Head.

Seascape has a large, airy double-aspect lounge with high ceilings, stunning recently fitted kitchen diner, 4 beautifully appointed double bedrooms, separate shower room and bathroom. Smoke alarms fitted throughout. There is a private parking space. (2nd parking space available by separate negotiation). The house is offered for sale fully furnished.

Entrance

Pillared entrance portico with key-safe, granite steps and part-glazed front door into:

Reception Porch

Wainscot paneled entrance vestibule with ceiling light, coat hanging space and Fired Earth tiled flooring. Original stained and etched glass paneled inner door with Victorian glass fanlight above, into:

Reception Hall

Stained and varnished original floorboards, dado rail, cornice, coving and corbels. Ceiling light, radiator, stairs rising to the first-floor half landing, doors leading to the lounge, kitchen-diner and useful under-stairs cupboard.

Living Room

Front: 11'05 x 11'01 (3.48m x 3.38m)

Double glazed sash window to the front elevation offering uninterrupted, panoramic sea views to Godrevy lighthouse and St Ives Bay. Original coving, picture rails and deep skirting. Pendant light fitting by designer Tim Rundle, stripped, stained and varnished original wood floorboards, power points and wall-mounted TV. Decorative fireplace recess. Contemporary column radiator.

Rear: 11'07 x 8'09 (3.53m x 2.67m)

Half glazed patio doors opening into private, walled courtyard with gate which opens onto Barnoon Hill. Power points. Picture rail, skirting. Floor as front section. Tim Rundle pendant light to match front. Contemporary column radiator.

Kitchen-Diner

Dining area: 12'00 x 7'08 (3.66m x 2.34m)

Double glazed window to side elevation. Painted and varnished floorboards. Cast iron style radiator. Dado rail to side. Slim painted beams in ceiling. Original Victorian built-in cupboard with small wine rack. Cupboard under breakfast bar. Lovely BTC porcelain pendant light fitting over table. Telephone and broadband connection.

Kitchen: 11'01(at the widest point) x 10'07 (3.38m(at the widest point) x 3.23m)

Flooring as dining area. Recently fitted 'L' shaped kitchen. Base units including 2 wide pan drawers



with "hidden" cutlery drawer. Under-counter, built-in dishwasher, fridge and freezer. Washer-drier. Polished granite worksurfaces, cooker splash-back and up-stands. Tiled wall behind sink with feature glass-block panel. Under-counter rectangular, stainless-steel sink with a Swan neck mixer tap and a carved granite drainer to the side. Integrated 4 ring gas hob with extractor fan above and built-in oven and grill below. Pantry-style matching larder cupboard housing the gas boiler, water sensor and leak detector, and CO2 detector. Dresser-style wall unit with central display shelving and 2 cupboards. 2 double-glazed Velux windows. 3 pendant glass lights hanging from pitched ceiling. 2 Neptune wall lights. Double glazed window. Stable door to courtyard.

From the hall, stairs up to half-landing. Original carved staircase with natural fibre carpet. Dado rail. Pendant light. Two matching opaque glazed doors opening into bathroom and shower room. Inset original coloured, backlit, glass panel installed into ceiling.

Bathroom

7'06 x 6'08 (2.29m x 2.03m)

Tiled flooring. Dual flush low-level w/c. Paneled "P"-shaped bath with mains shower above and recessed shelf. Villery & Boch basin and vanity unit with drawers below. Tiled splash back. Ladder-style, dual-fuel towel rail. Obscure double-glazed window with blind to side aspect. Fully tiled walls next to bath. Extractor fan, ceiling light. Loft access.

Shower Room

5'00 x 4'09 (1.52m x 1.45m)

Tiled flooring. Dual flush low-level w/c. Tiled, corner electric shower with glazed doors. Slimline vanity basin. Ladder towel rail. Extractor fan and ceiling light. Obscure double-glazed window with blind to the side aspect.

Returning to the half landing. There are stairs rising to the upper landing and doors into:

Bedroom 1

11'06 x 10'03 (3.51m x 3.12m)

Floorboards. Radiator. Double glazed sash window to the front aspect offering a stunning 180-degree view from the Island around to Porthminster point and taking in the whole

of St Ives bay across to Godrevy and beyond to Trevoise head in the distance.

Bedroom 2

11'06 x 8'00 (3.51m x 2.44m)

Floorboards. Radiator. Double glazed window to the front aspect offering a stunning view into the harbour, Island and out into St Ives bay and across to Godrevy Lighthouse and beyond to Trevoise head in the distance.

Bedroom 3

9'05 x 8'09 (2.87m x 2.67m)

Floorboards. Radiator. Double glazed window to the rear aspect. Recessed floor to ceiling shelving. Built in wardrobe with hanging and shelves. Original, slim, built-in Victorian cupboards.

Returning to the upper landing there is a further door that accesses the carpeted stairs that lead to the:

Master Bedroom

13'03 x 11'06 (4.04m x 3.51m)

White, wood-paneled walls and bonnet ceiling with exposed beams. 4 large storage cupboards in the eaves. Carpet. Double glazed sash dormer windows to the rear aspect and a double glazed sash window to the front which offers a truly stunning 180 degree view from the east end of Porthmeor and The Island, into the Harbour and across to Porthminster point and taking in the full vista of St Ives Bay and across to the North cliffs of Hayle, Godrevy lighthouse and Trevoise head in the distance.

Outside

Valuable, easily accessible, parking space at the end of the terrace walkway. (2nd, adjoining space available by separate negotiation)

The property is approached off the pedestrian walkway via a shared gate and path to the front door. The gravelled, Mediterranean style garden contains many fine specimen plants. The raised, paved sun terrace which runs across the front of the property enjoys fabulous harbour and bay views, creating an ideal alfresco dining area or the perfect spot to sit and enjoy a glass of wine and look out into the bay.

This section of the garden is finished with galvanized railings

and gate.

Across the footpath from the front of the property is an enclosed, partly walled garden which has been landscaped and planted with unusual, semi-tropical shrubs, plants and palms. There are three seating areas; two with tables and chairs and one garden bench. There is a raised seating area at the top of the garden with lovely views. The larger dining area, with a built-in slate table at the bottom of the garden enjoys the last of the evening sun. Agents Note: There is a right of access, along the path through this part of the garden, to the owner of the property beyond.

To the rear of the property is an enclosed, walled courtyard garden with a small beach-hut styled shed, plants in contemporary containers, a low teak table and two chairs. There is an outside shower, separate tap and a retractable washing line; an ideal area to hang wetsuits, store surfboards, and wash off those sandy toes after a day spent on the beach.

Parking

There is one parking space with the property which are located at the end of Barnoon Terrace. A second parking space is available to be purchased by separate negotiation.

Viewing

By appointment only. The property is used as a holiday let so please ensure that your appointment is confirmed before travelling to the area.

GROUND FLOOR
498 sq.ft. (46.2 sq.m.) approx.

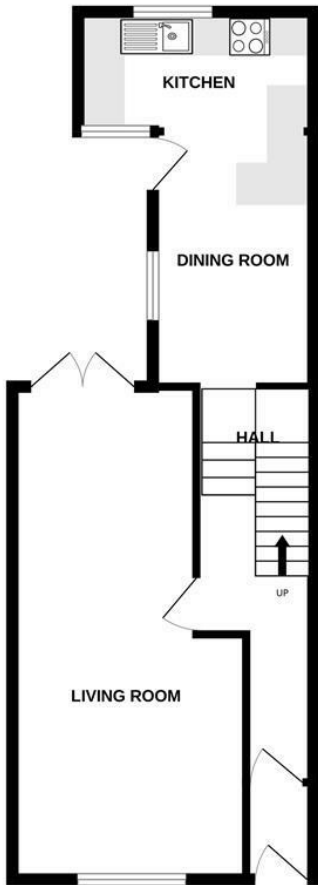

1ST FLOOR
478 sq.ft. (44.4 sq.m.) approx.



2ND FLOOR
213 sq.ft. (19.8 sq.m.) approx.

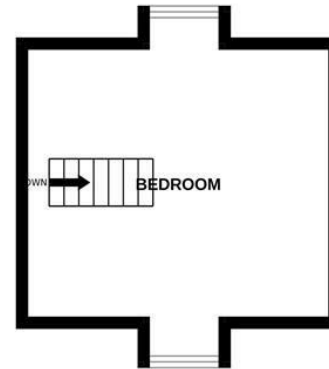

TOTAL FLOOR AREA : 1188 sq.ft. (110.4 sq.m.) approx.

Whilst every attempt has been made to ensure the accuracy of the floorplan contained here, measurements of doors, windows, rooms and any other items are approximate and no responsibility is taken for any error, omission or mis-statement. This plan is for illustrative purposes only and should be used as such by any prospective purchaser. The services, systems and appliances shown have not been tested and no guarantee as to their operability or efficiency can be given.
Made with Metropix ©2024

Energy Efficiency Rating		Current	Potential
Very energy efficient - lower running costs			
(92 plus) A			83
(81-91) B			
(69-80) C			
(55-68) D			
(39-54) E			
(21-38) F		66	
(1-20) G			
Not energy efficient - higher running costs			
England & Wales		EU Directive 2002/91/EC	

TO ARRANGE A VIEWING PLEASE
CONTACT
St Ives Sales Office
01736 798833
st.ives@millerson.com

from Unfair Trading Regulations 2008: The Agent has not
equipment, fixtures and fittings or services and so cannot
working order or fit for the purpose, buyers are advised to
m their Solicitor or Surveyor. References to the Tenure are
supplied by the Seller as the Agent has not had sight of
again buyers are advised to obtain verification from their
in photographs are not included unless specifically
sales particulars although sometimes however they may
viate negotiation. Buyers are strongly recommended to
of any property and make an appointment to view before
ourney to see a property. Reproduced by permission of
behalf of the Controller of Her Majesty's Stationery Office.
rights reserved. License number 10011628

www.millerson.com





www.millerson.com

 Millerson
Select

