

Bravington Road, W9

£553 Per week

This ground floor garden flat was recently refurbished by the landlord and would be ideal for a couple or professional sharers. It has two double bedrooms, reception room, separate kitchen and a patio garden.

Bravington Road is located between Queens Park and the Harrow Road allowing easy access to the local shops including the new M&S food and the multiple transport links that both areas have to offer.

Features

Period Conversion
Two Bedrooms
Ground Floor Flat
Recently Refurbished
Patio Garden
Fantastic Location

Bravington Road, Maida Vale, W9

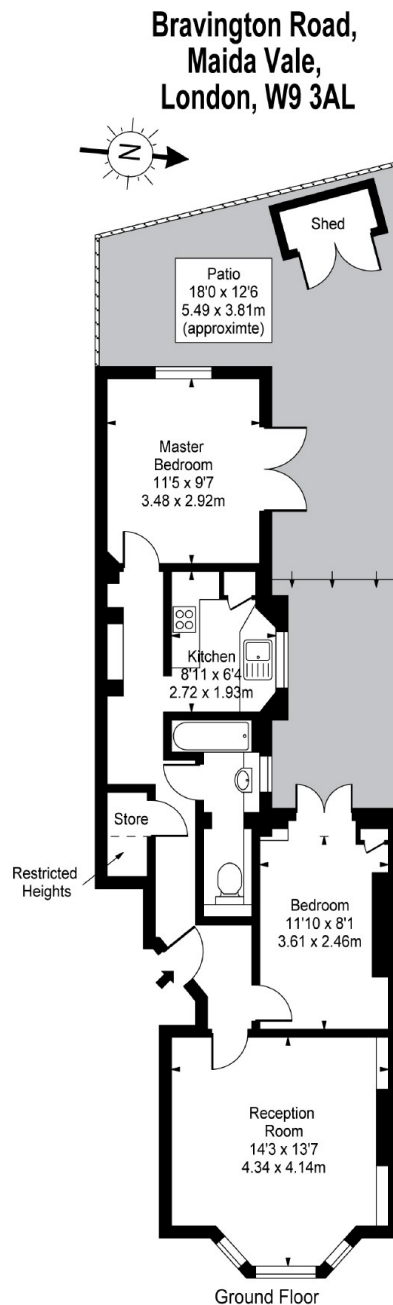

Approx Gross Internal Area 633 Sq Ft - 58.88 Sq M

For Illustration Purposes Only - Not To Scale Floor Plan by www.nogaphotostudio.com Ref: No.10019

This floor plan should be used as a general outline for guidance only. Any intending purchaser or lessee should satisfy themselves by inspection, searches, enquiries and full survey as to the correctness of each statement. Any areas, measurements or distances quoted are approximate and should not be used to value a property or be the basis of any sale or let.

Dexters

Maida Vale
298 Elgin Avenue
London
W9 1JS
Lettings
020 7266 2021

Energy Rating: E. We aim to make our particulars both accurate and reliable. However they are not guaranteed; nor do they form part of an offer or contract. If you require clarification on any points then please contact us, especially if you're traveling some distance to view. Please note that appliances and heating systems have not been tested and therefore no warranties can be given as to their good working order.

 **RICS** | Regulated
Estate Agent
and Letting Agent

dexters.co.uk